

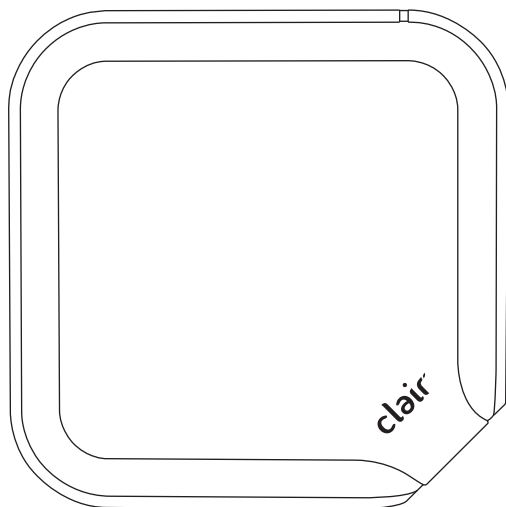

공기청정기 • Air Purifier • 空气净化器

Instruction Manual



MODEL	C1BU1933	
Power Supply	Input	Output
	AC 100-240V / 50/60Hz	DC 12V / 1.0A
Power Consumption	Min 2W ~ Max 6W	
Dimension	274 x 274 x 147 mm	
Weight	2.7 kg	

Special Features

By combining three-stages filtration technology, the clair CUBE air purifier improves collection efficiency than existing single filtering system. The CUBE delivers clean air from the back to the top and the strong fan of the CUBE makes room air more pleasant as quickly.



Innovative MAF Technology

The MAF (Magnetic Air Filtration) Technology revolutionized the air purifier industry by combining plasma ionizers and E2F filters which were patented in Europe. In the Charging section, the air pollutants are charged with (+,-) polarity, and in the Trapping section, those polar particles are trapped between the filters by electrostatic attraction. This process traps not only viruses, pollens, bacteria, and VOCs, but also ultrafine dust with the radius of less than 0.1 μ m.



LED Sterilizer

Unlike conventional UV lamp, the clair CUBE uses in-direct bactericidal method of Violet blue light, which is harmless to humans and has excellent antibacterial capabilities. It helps to keep filter performance longer by sterilizing and removing various contaminants on the surface of the filter. The LED light can also be used as a mood in the dark indoor space.



Energy Efficiency

The clair CUBE has very low power consumption by spending just 6 watts even in high speed mode. It keeps users to save cost and to enjoy fresh air all the time.



Easy Maintenance

Removing large chunks of dust on the surface of the filter every 1~2 months would ensure that the effectiveness of the filter lasts longer. Easy and simple replacement to new filter by user. (recommended interval of filter replacement is 12 months)



Low Noise level

As the clair CUBE produces a noise level of less than 40dB even at its high speed mode, it can be used while studying or sleeping without creating any disruption.



Attractive Design

Make a natural harmony in all interior and the curve with the 4 corners of the product design makes a soft feeling.



Ideal Placement

The attractive design of the clair CUBE is easy to install and move at any places due to its compact size and shape. The clair CUBE provides fresh air constantly around it is placed.



Made in Korea

All models are made in Korea to ensure customer reliability.

Product Components

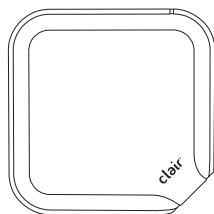

• Main Body

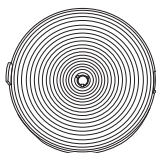

• E2F Filter



• DC Adapter



• User Manual

Installation Method

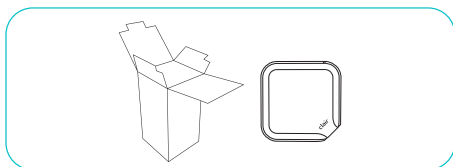

1. Check the status of the product before the installation.

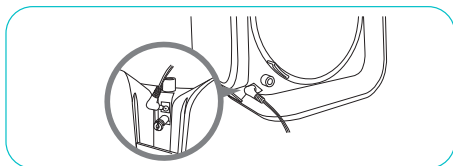

3. As shown in the picture, connect the product's body with the adapter.

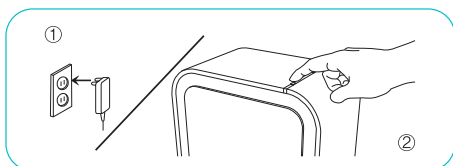

5. Plug in a power outlet and press the power button to operate the product.

Names of Each Part

Front

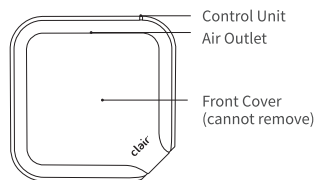

Back

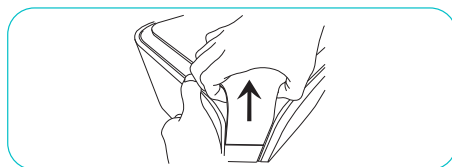
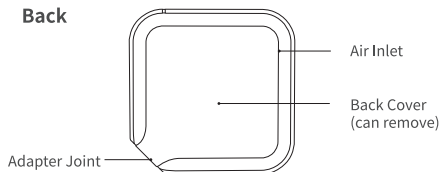

2. As shown in the picture, disassemble the back cover from the body by grabbing and pulling the edge of the back cover.

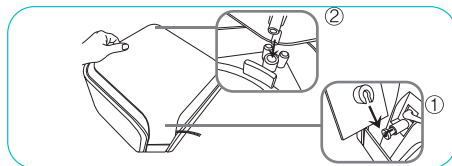

4. As shown in the picture, slide the edge of the back cover into the groove of body smoothly and make sure that the diagonal support engages with each other.

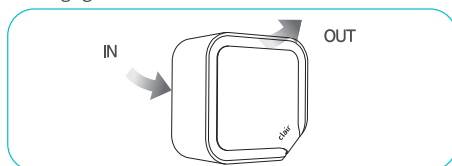



6. Be careful not to block the back cover with foreign objects as not prevent air intake.

※ **CAUTION!** You must connect DC Adapter to the product first and then connect to the outlet.

Operation Guide

Operation Method and Motion

Operation Mode	Operation Method	Operation Details	Button Indicator	LED Indicator
Level 1	Press the power button once	Low speed mode		•
Level 2	Press the power button twice	Normal speed mode		••
Level 3	Press the power button 3 times	High speed mode		•••
OFF	Press the power button 4 times	OFF		
Power LED OFF	Press the power button for longer than 2 seconds regardless of mode	Power LED OFF		
ionizer ON / OFF	Press the mode button for longer than 3 seconds	ionizer ON / OFF		ion
UV LED ON / OFF	Press the mode button once	UV LED ON / OFF		uv

Recommended Installation Place

한국어

English

中文

Bed room



Living room

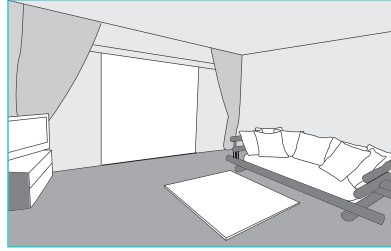

Children's room

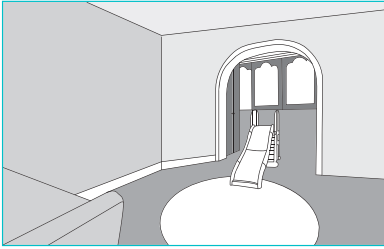

Study room



Kitchen

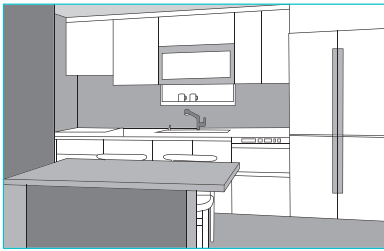

Studio

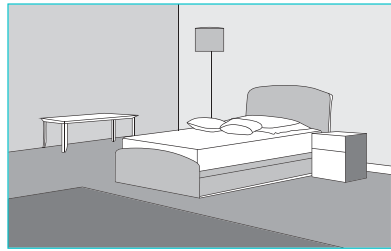

Office

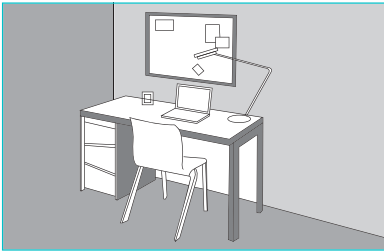

Hospital room

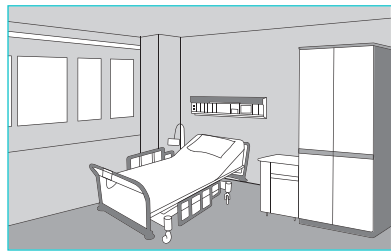

Maintenance

How to Clean the Filter

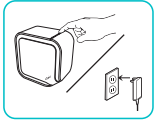

1. Turn the power off and unplug from power outlet.

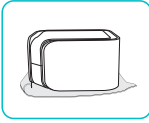

2. Lay the product down with back cover facing upwards.



3. Hold the handle and disassemble the back cover.



4. Remove dust at the top of the E2F filter using a vacuum cleaner.

※Caution!

Make sure to start cleaning and filter management after turning off power, unplugging from power outlet and making sure that the fan has stopped. There is danger for electric shock or other accidents if filter is changed during operation.

How to Change the Filter

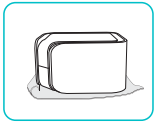

1. Lay the product down with back cover facing upwards.

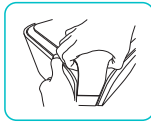

2. Hold the handle and disassemble the back cover.

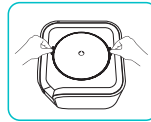

3. Hold the handles on both side of the E2F filter and disassemble the E2F filter from main body.
4. Change th a clean unused filter.

Caution for Maintenance



Filters last for a maximum of 12 months which is subject to change depending on installation place and environmental conditions.



Cleaning the filters with water is not recommended. It may decrease purification ability due to reduced filter function.

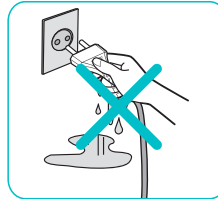

Do not touch power cord with wet hands, for danger of electric shock or other accidents.

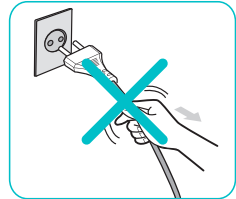

Do not pull on the cable of the power plug. It may cause damage to the cable or injury.



Do not use water or detergent when cleaning the body or filter. It may cause stains or cracks on the surface.

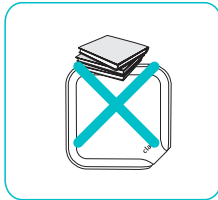

Do not place any objects on the product. It may block the inlet or outlet causing malfunction or reduced ability of purification.



Keep children from climbing on and putting fingers or other foreign matter in the outlet, as this could cause injury.

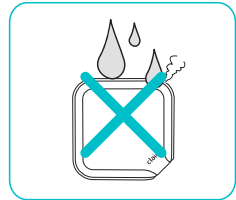

Be careful that water is not allowed the inside product. It may cause a fire or electric shock.

Caution for Safety

Caution for Power

- Do not change or extend cable.
- Do not bend power plug or pull as it may cause damage.
- Do not pull power plug cable.
- Do not use damaged power cords, plugs or loosened outlets.
- Do not use multiple devices simultaneously on a single power strip.
- Do not use power plug near a heater.
- Use rated adapter (DC 12V/1.0A rating).
- Pull out power plug from outlet in the event of cleaning.
- Do not touch power plug with wet hands.
- Pull plug out when product is not in use.
- Be careful as not to let an infant access or operate the product.

※ Failure to follow these instructions could lead to damage or injury by electric shock or fire.

Caution for Use and Placement

- Do not use the product in a place where gas may be leaked.
- Do not use the product in a place with industrial oil smoke or metallic dust.
- Do not use under direct sunlight, near heaters or in humid conditions.
- Do not place on a slope or uneven surface.
- Install at least 20cm away from surrounding objects.
- Check if there are any obstacles blocking air inlet or outlet part.
- Do not move the product by holding the back cover only.

※ Failure to follow these instructions could lead to reduced purification ability, abnormal noise or malfunction. And it may cause damage or injury by electric shock or fire.

Caution for Operation

- Use the product when plug is fully fixed so that power plug does not shake.
- Do not block air inlet and outlet with other foreign matter.
- Do not use it near hot object like a stove or fire risky places.
- Do not use the product on its side or back and do not put any object on the top.
- Do not use when body and filter are separated.
- Do not use detergent to clean the surface of the product.

※ Failure to follow these instructions could lead to fire, malfunction, damage to product or reduced purification ability.

Caution for Filter

- Avoid making direct contact with filters in use such as smelling or touching.
- For polluted filters, open back cover and remove dust only using a vacuum cleaner.
- Cleaning with water is not recommended as it may cause filter function decrease.
- If the product is not used for long durations or time, pollutants may be collected in the filter. Seal the filter using a plastic cover and store it.

※ Failure to follow these instructions could lead to health problems or functional reduction of E2F filter.

Warranty Certificate

CLAIR, Inc. implements the warranty of the product as below according to the consumer indemnification regulation.

- * The warranty period of Clair product is 1 year from the purchase date.
- * The compensation and reception notice shall be made within 7 days from application date, and repair and compensation shall be made within 14 days from the application date. (excluding holiday and national holidays)
- * The below shall be subject to paid repair.
 - In case of failure by using non-authentic components
 - In case of failure by negligence of user or by arbitrary repair and modification
 - In case of failure by non-implementation of matters defined in the user manual
- * Paid repair is available after the warranty period.
- * provide warranty certificate in the event of repair application.

Customer service center 080-581-2917

Customer Information	
Name	
Address	
Tel.	
Mobile	
E-mail	
Product name	clair CUBE Air Purifier
Model name	C1BU1933
Date of purchase	year month date
Warranty period	1 year from purchase date
Manufacturing date	Indicated separately
Manufacturer	CLAIR, Inc.
Homepage	www.clair.kr

※ Please safely store this certificate with your user manual as it cannot be re-issued.

MEMO



Customer service center

080-581-2917

clair
CLAIR, Inc.

Inquiry and consulting

2nd Floor, 148, Gangnam-daero, Seocho-gu, Seoul, Korea

TEL +82.2.581.2918

FAX +82.2.581.2919

WEB www.clair.kr

E-MAIL cs@clair.kr