

# FUSE BLOCK

Electric Parts

## R3-100-11-4110 *Wiring / Blade Fuse*

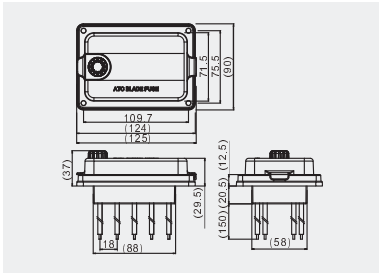

WIRE	32V DC max Output: 20A max per circuit
FUSE	BLADE FUSE

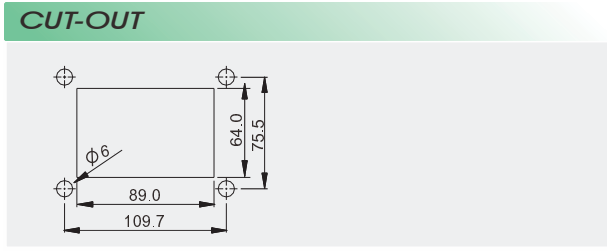

**FEATURES:**

- Material:  
Base: PBT (UL flame: 94V-0).  
Cap: PC (UL flame: 94V-2).
- Output terminal rating: wire size #12 AWG.
- Connection wire option available.
- Identify circuits by foot print marking.
- Insulating cover design for dust proof.
- Easy to open by pressing the latch.

## R3-101 *Stackable Relay Block*

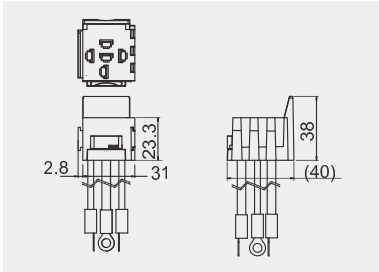

	12V/24V DC
--	------------

**FEATURES:**

- Material:  
Frame: nylon with glass fiber.

**RELAY DIM**

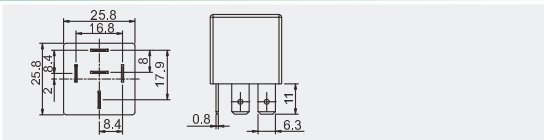

**\*This Relay Block could string array.**

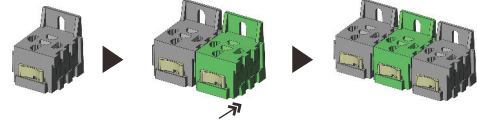

## R3-103 *Automotive bolt-in fuse holder | MEGA Fuse*

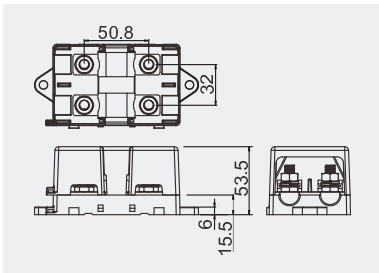

	32V DC, 40A~400A (max.)
FUSE	MEGA FUSE

**FEATURES:**

- Material:  
Cover: PBT.  
Housing: nylon.  
Screw: Ni plated steel studs.
- M8 threaded studs and hex nut for fuse mounting.
- Torque rating: 20in-lb (2.25 Nm) max.
- Mounting torque rating: 12-18Nm max. M8 screws with washers.

**CUT-OUT**

