

Fuse Holder

RT18



RT18-32X 1P



RT18-63/2P



RT18M-32X/3P

Type	Assorted Fuse	Rated Voltage (V)	Rated Current (A)	Weight (kg)	Dimension (mm)				
					A	B	C	D	E
RT18-32 1P	10 x 38	380	32	0.075	82	78	35	63	18
RT18-32 2P			32	0.15	82	78	35	63	36
RT18-32 3P			32	0.22	82	78	35	63	54
RT18-63 1P	14 x 51		63	0.18	106	103	35	80	26
RT18-63 2P			63	0.36	106	103	35	80	52
RT18-63 3P			63	0.54	106	103	35	80	78
RT18-32X 1P	10 x 38		32	0.075	82	78	35	63	18
RT18-32X 2P			32	0.15	82	78	35	63	36
RT18-32X 3P			32	0.22	82	78	35	63	54
RT18-63X 1P	14 x 51		63	0.18	106	103	35	80	26
RT18-63X 2P			63	0.36	106	103	35	80	52
RT18-63X 3P			63	0.54	106	103	35	80	78

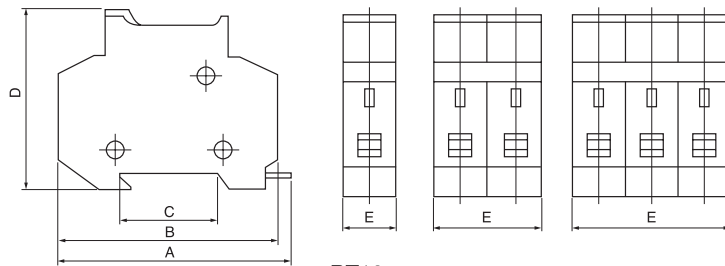

RT18

RT18L



RT18L

Type	Assorted Fuse	Number of Poles	Rated Insulation Voltage (V)	Conventional heating current (A)	Dimension (mm)				
					A1	A2	B	H1	H2
RT18L-63	14 x 51	1, 2, 3, 4	690	63	108	115	27	78	100
RT18L-125	22 x 58			125	126	134	36	78	104

HG30

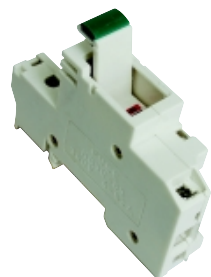

HG30

Type	Assorted Fuse	Number of Poles	Rated Insulation Voltage (V)	Conventional heating current (A)	Dimension (mm)					
					A1	A2	B	H1	H2	ød
HG30-63	14 x 51	1, 2, 3, 4	500	63	107	80	27	80	102	4.5
HG30-125	22 x 58			125	140	110	36	90	109	4.5

Dimension

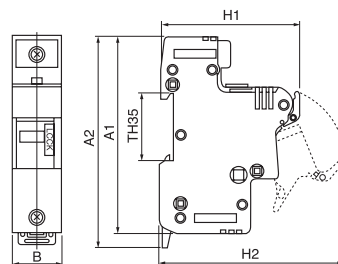

RT18L

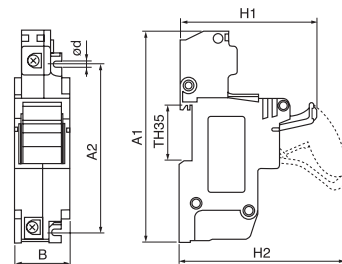

HG30