

GPS ANTENNA - SMA-C 90°



Using the magnetic foot you can simply attach the antenna below/on the car dashboard, under luggage cover or in any other location. The assembly is very easy. Plug in the cable, stick on the antenna with magnet or just the way you prefer, lay the wire – done!

Gain quality of this antenna is in nothing inferior of outside aerials.

Antena with SMA C connector can be used with:

- Alpine Blackbird PMD-B100 Portable Navigation System
- Heedfeld HE2000
- Falcom - FAL-ANT-4)
- GlobalSat G5040 5010U
- Navman Tracker 5100, 5110, 5110X, 5110i, 5380, 5380i, 5430, 5430i, 5500, 5500X, 5500i, 5505, 5505i, 5600, 5605
- Trimble GPS Receivers: TNL1000 Aviation GPS, Trimble 2000A

Below product specification guarantees the quality of our product as a single unit.

Electrostatic sensitive device. Observe precautions for handling.

Electrical characteristics		
Antenna		
1	Frequency Range	1575,42MHz±1,02 MHz
2	V.S.W.R	1,5:1
3	Band Width	> 10 MHz
4	Impedence	50 ohm
5	Gain	5dBic based on 7x7cm ground plane
6	Polarization	RHCP
LNA		
1	Frequency Range	1575,42MHz±1,02 MHz
2	DC Voltage	3 - 5V
3	Gain	28±3dB
4	Out-of-band rejection (absolute value)	≥25dB (antenna frequency +100MHz) ≥40dB (antenna frequency -100MHz)
5	Output VSWR	1,5
6	Noise figure	1,2
7	DC current	10,5 mA
		
Overall (Complete module including RF connector)		
1	Frequency Range	1575,42MHz±1,02 MHz
2	Output VSWR	1,5
3	Gain	26±3dBic
4	Impedence	50 ohm

Material			
No.	Part Name	Specification	
1	Antenna	Dielectric Ceramics	
2	PCB	FR4	
3	Shielding	Tinplate	
4	RF Cable	RG174	
		Attenuation: 1,3dB/m	
		Length - 500±5cm	
5	RF Connector	SMA-C	
6	Dimensions	49,5 x 40,2 x 15,5mm ±0,5mm	

Environment condition		
1	Working temp.	-25°C ~ +65°C
2	Storage temp.	-45°C ~ +86°C
3	Vibration	Sine sweep 1g(0-p) 10~55~10Hz each axis
4	International Protection	IP67

Patch test curve (test conditions: 27x27mm ground):

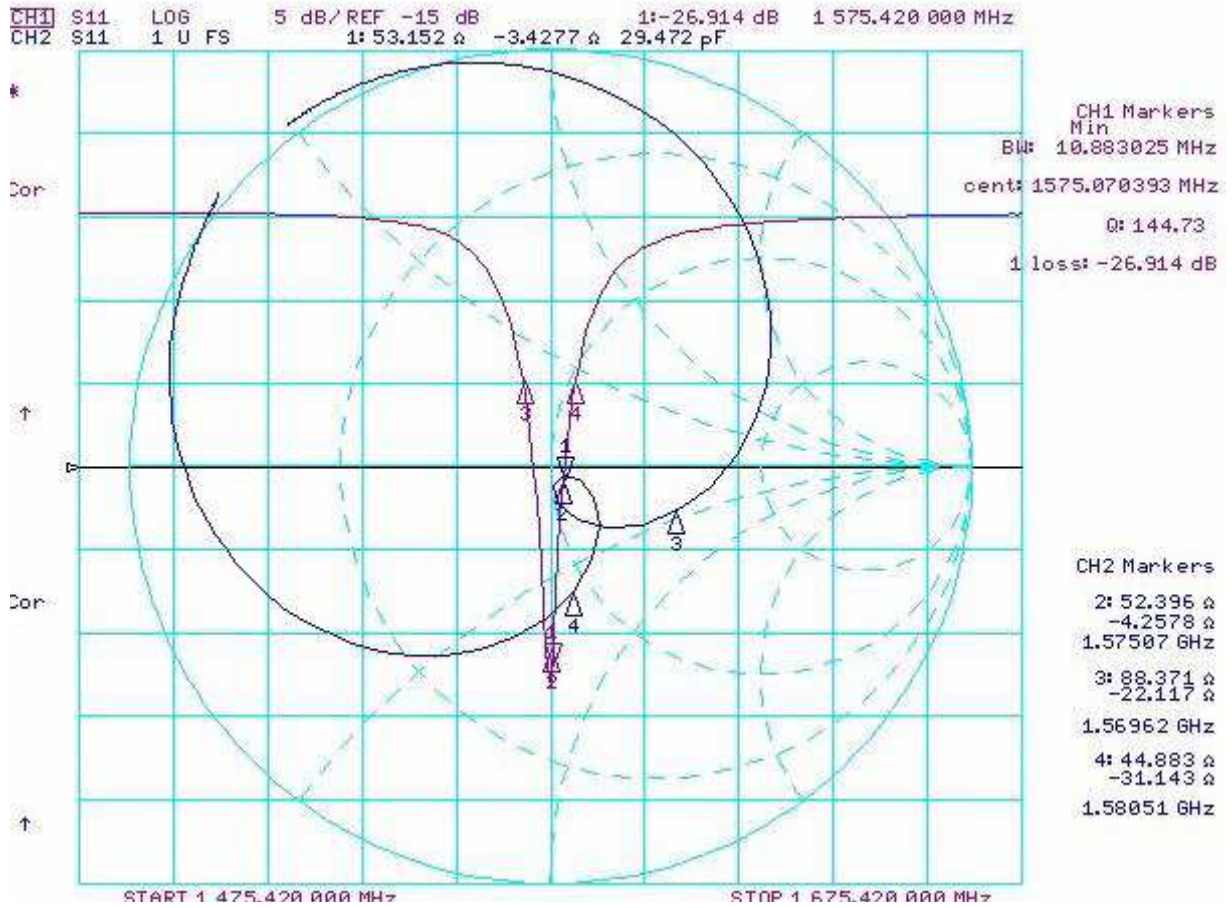

LNA test curve (test conditions: DC 3,0V):

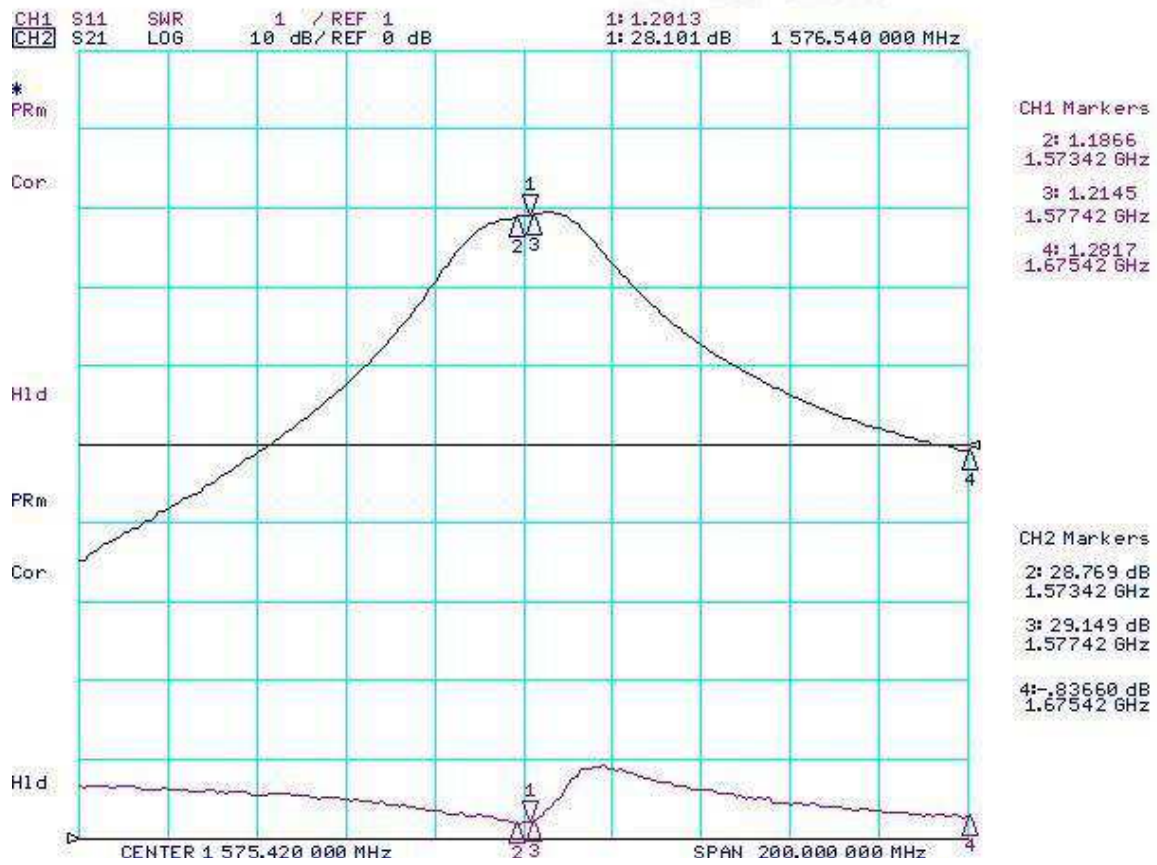

Dimensions:

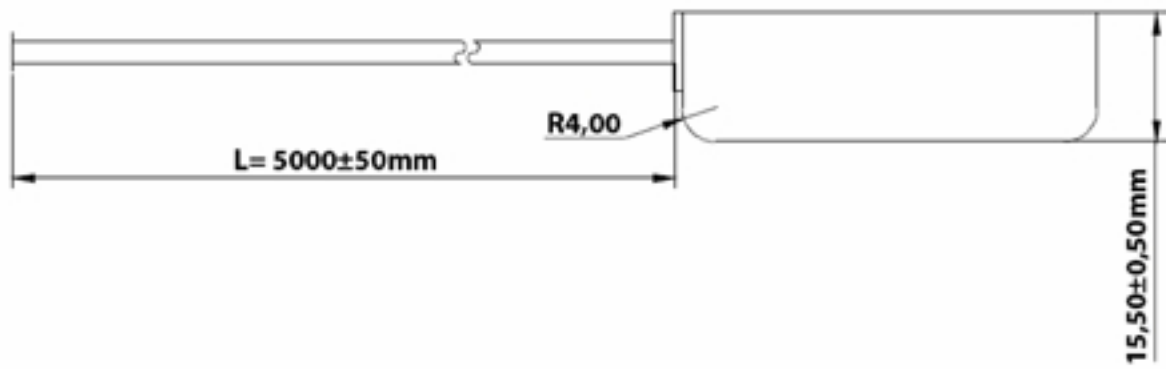
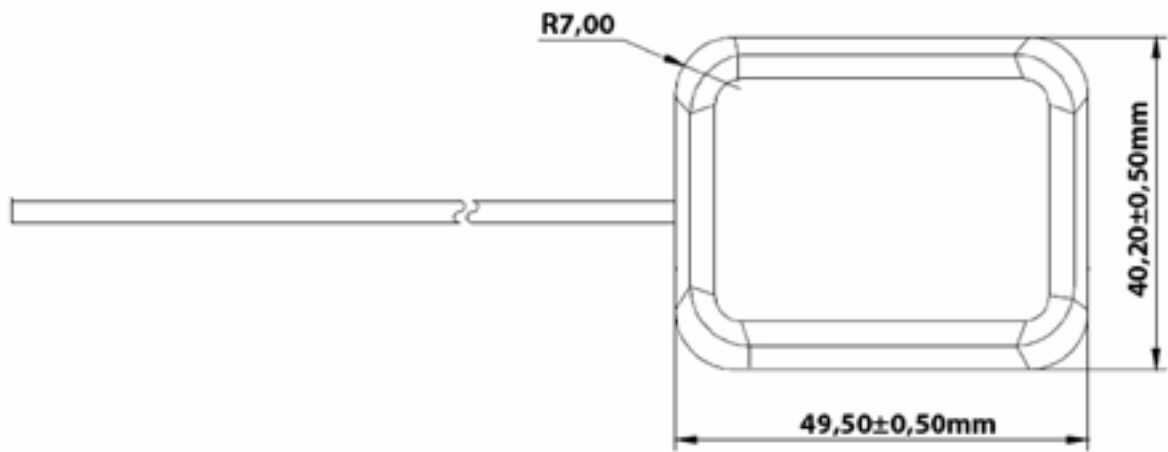

SMA-C connector:

