

Model No.: GP75AAH

Type	: Rechargeable Nickel Metal Hydride Cylindrical Cell
Nominal Dimension (with Sleeve)	: $\Phi = 14.5\text{mm}$ H = 28.7mm
Applications	: Recommended discharge current 75 to 2250mA
Nominal Voltage	: 1.2V
Capacity	: Nominal: 750mAh Minimum: 750mAh Typical: 770mAh When discharged at 150mA to 1.0V at 20°C
Charging Condition	: 75mA for 16 hrs at 20°C
Fast Charge	: 375mA to 750mA (0.5 to 1C) charge termination control recommended control parameters: - ΔV : 0-5mV DT/dt : 0.8°C/min (0.5 to 0.9C) 0.8 - 1°C/min (1C) TCO : 45 - 50°C Timer : 105% nominal input (for ref. only)
Service Life	: >500 cycles (IEC standard)
Continuous Overcharge	: 75mA maximum current for 1 year. No conspicuous deformation and/or leakage
Weight	: 15.0g
Internal Resistance	: Average 35m Ω upon fully charged (Max. 45m Ω) at 1000Hz
Max. Charging Voltage	: 1.5V at 75mA charging
Ambient Temperature Range	: Standard Charge : 0 to 45°C Fast Charging : 10 to 45°C Discharge : -20 to 50°C Storage : -20 to 35°C

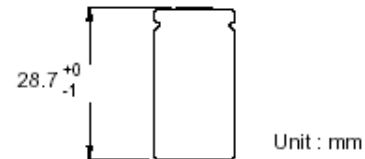

Low Rate Discharge

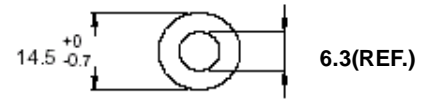
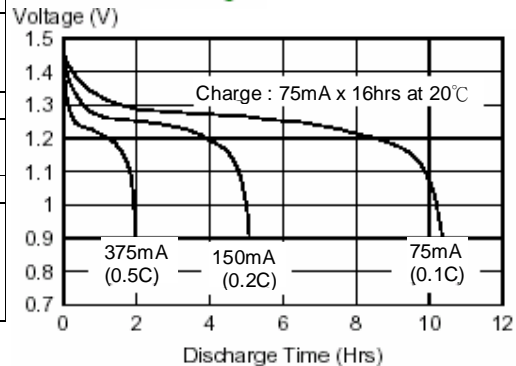

Fast Charge (Charge control required)

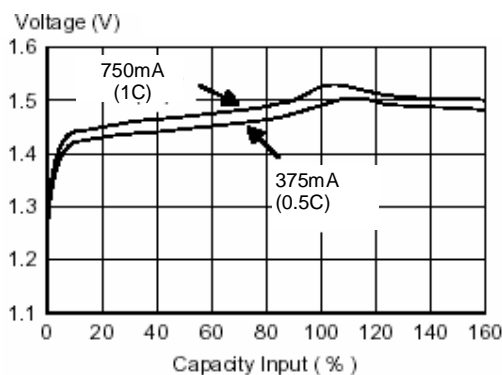

High Rate Discharge

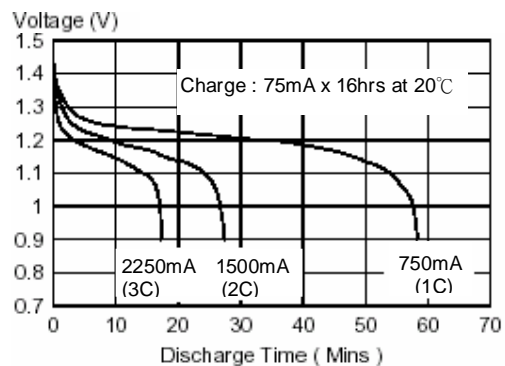

The information (subject to change without prior notice) contained in this document is for reference only and should not be used as a basis for product guarantee or warranty. For applications other than those described here, please consult your nearest GP Sales and Marketing Office or Distributors.