

**DECENT CURRENT INDUCTIVE SWITCHES □ 18x1**

**Special features**



- Detecting without contact.
- High speed response.
- High degree of protection.
- Reverse polarity protection.
- Overvoltage protection.

	output	detecting distance	housing	body material	connection	indication
ID18P1E1	PNP/NO	5mm	1	brass(chrome plated)	cable	-
ID18P1E1L	PNP/NO	5mm	1	brass(chrome plated)	cable	LED
ID18P1E1C	PNP/NO	5mm	3	brass(chrome plated)	coupling	-
ID18P1E1CL	PNP/NO	5mm	3	brass(chrome plated)	coupling	LED
ID18P1ES1	PNP/NO	5mm	2	brass(chrome plated)	cable	-
ID18P1ES1L	PNP/NO	5mm	2	brass(chrome plated)	cable	LED
ID18P11	PNP/NO	7mm	4	brass(chrome plated)	cable	-
ID18P11L	PNP/NO	7mm	4	brass(chrome plated)	cable	LED
ID18P11C	PNP/NO	7mm	6	brass(chrome plated)	coupling	-
ID18P11CL	PNP/NO	7mm	6	brass(chrome plated)	coupling	LED
ID18P12	PNP/NO	7mm	4	PVC	cable	-
ID18P12L	PNP/NO	7mm	4	PVC	cable	LED
ID18P12C	PNP/NO	7mm	6	PVC	coupling	-
ID18P12CL	PNP/NO	7mm	6	PVC	coupling	LED
ID18P1S1	PNP/NO	7mm	5	brass(chrome plated)	cable	-
ID18P1S1L	PNP/NO	7mm	5	brass(chrome plated)	cable	LED
ID18P1S2	PNP/NO	7mm	5	PVC	cable	-
ID18P1S2L	PNP/NO	7mm	5	PVC	cable	LED
ID18P2E1	PNP/NC	5mm	1	brass(chrome plated)	cable	-
ID18P2E1L	PNP/NC	5mm	1	brass(chrome plated)	cable	LED
ID18P2E1C	PNP/NC	5mm	3	brass(chrome plated)	coupling	-
ID18P2E1CL	PNP/NC	5mm	3	brass(chrome plated)	coupling	LED
ID18P2ES1	PNP/NC	5mm	2	brass(chrome plated)	cable	-
ID18P2ES1L	PNP/NC	5mm	2	brass(chrome plated)	cable	LED
ID18P21	PNP/NC	7mm	4	brass(chrome plated)	cable	-
ID18P21L	PNP/NC	7mm	4	brass(chrome plated)	cable	LED
ID18P21C	PNP/NC	7mm	6	brass(chrome plated)	coupling	-
ID18P21CL	PNP/NC	7mm	6	brass(chrome plated)	coupling	LED
ID18P22	PNP/NC	7mm	4	PVC	cable	-
ID18P22L	PNP/NC	7mm	4	PVC	cable	LED
ID18P22C	PNP/NC	7mm	6	PVC	coupling	-
ID18P22CL	PNP/NC	7mm	6	PVC	coupling	LED
ID18P2S1	PNP/NC	7mm	5	brass(chrome plated)	cable	-
ID18P2S1L	PNP/NC	7mm	5	brass(chrome plated)	cable	LED
ID18P2S2	PNP/NC	7mm	5	PVC	cable	-
ID18P2S2L	PNP/NC	7mm	5	PVC	cable	LED
ID18P3E1	PNP/NP+NC	5mm	1	brass(chrome plated)	cable	-
ID18P3E1L	PNP/NP+NC	5mm	1	brass(chrome plated)	cable	LED



# STS Electronics Ltd

P. O. Box 601, 5300 Gabrovo, BULGARIA

ID18P3E1C	PNP/NP+NC	5mm	3	brass(chrome plated)	coupling	-
ID18P3E1CL	PNP/NP+NC	5mm	3	brass(chrome plated)	coupling	LED
ID18P3ES1	PNP/NP+NC	5mm	2	brass(chrome plated)	cable	-
ID18P3ES1L	PNP/NP+NC	5mm	2	brass(chrome plated)	cable	LED
ID18P31	PNP/NP+NC	7mm	4	brass(chrome plated)	cable	-
ID18P31L	PNP/NP+NC	7mm	4	brass(chrome plated)	cable	LED
ID18P31C	PNP/NP+NC	7mm	6	brass(chrome plated)	coupling	-
ID18P31CL	PNP/NP+NC	7mm	6	brass(chrome plated)	coupling	LED
ID18P32	PNP/NP+NC	7mm	4	PVC	cable	-
ID18P32L	PNP/NP+NC	7mm	4	PVC	cable	LED
ID18P32C	PNP/NP+NC	7mm	6	PVC	coupling	-
ID18P32CL	PNP/NP+NC	7mm	6	PVC	coupling	LED
ID18P3S1	PNP/NP+NC	7mm	5	brass(chrome plated)	cable	-
ID18P3S1L	PNP/NP+NC	7mm	5	brass(chrome plated)	cable	LED
ID18P3S2	PNP/NP+NC	7mm	5	PVC	cable	-
ID18P3S2L	PNP/NP+NC	7mm	5	PVC	cable	LED
ID18N1E1	NPN/NO	5mm	1	brass(chrome plated)	cable	-
ID18N1E1L	NPN/NO	5mm	1	brass(chrome plated)	cable	LED
ID18N1E1C	NPN/NO	5mm	3	brass(chrome plated)	coupling	-
ID18N1E1CL	NPN/NO	5mm	3	brass(chrome plated)	coupling	LED
ID18N1ES1	NPN/NO	5mm	2	brass(chrome plated)	cable	-
ID18N1ES1L	NPN/NO	5mm	2	brass(chrome plated)	cable	LED
ID18N11	NPN/NO	7mm	4	brass(chrome plated)	cable	-
ID18N11L	NPN/NO	7mm	4	brass(chrome plated)	cable	LED
ID18N11C	NPN/NO	7mm	6	brass(chrome plated)	coupling	-
ID18N11CL	NPN/NO	7mm	6	brass(chrome plated)	coupling	LED
ID18N12	NPN/NO	7mm	4	PVC	cable	-
ID18N12L	NPN/NO	7mm	4	PVC	cable	LED
ID18N12C	NPN/NO	7mm	6	PVC	coupling	-
ID18N12CL	NPN/NO	7mm	6	PVC	coupling	LED
ID18N1S1	NPN/NO	7mm	5	brass(chrome plated)	cable	-
ID18N1S1L	NPN/NO	7mm	5	brass(chrome plated)	cable	LED
ID18N1S2	NPN/NO	7mm	5	PVC	cable	-
ID18N1S2L	NPN/NO	7mm	5	PVC	cable	LED
ID18N2E1	NPN/NC	5mm	1	brass(chrome plated)	cable	-
ID18N2E1L	NPN/NC	5mm	1	brass(chrome plated)	cable	LED
ID18N2E1C	NPN/NC	5mm	3	brass(chrome plated)	coupling	-
ID18N2E1CL	NPN/NC	5mm	3	brass(chrome plated)	coupling	LED
ID18N2ES1	NPN/NC	5mm	2	brass(chrome plated)	cable	-
ID18N2ES1L	NPN/NC	5mm	2	brass(chrome plated)	cable	LED
ID18N21	NPN/NC	7mm	4	brass(chrome plated)	cable	-
ID18N21L	NPN/NC	7mm	4	brass(chrome plated)	cable	LED
ID18N21C	NPN/NC	7mm	6	brass(chrome plated)	coupling	-
ID18N21CL	NPN/NC	7mm	6	brass(chrome plated)	coupling	LED
ID18N22	NPN/NC	7mm	4	PVC	cable	-
ID18N22L	NPN/NC	7mm	4	PVC	cable	LED
ID18N22C	NPN/NC	7mm	6	PVC	coupling	-
ID18N22CL	NPN/NC	7mm	6	PVC	coupling	LED
ID18N2S1	NPN/NC	7mm	5	brass(chrome plated)	cable	-
ID18N2S1L	NPN/NC	7mm	5	brass(chrome plated)	cable	LED
ID18N2S2	NPN/NC	7mm	5	PVC	cable	-
ID18N2S2L	NPN/NC	7mm	5	PVC	cable	LED

ID18N3E1	NPN/NO+NC	5mm	1	brass(chrome plated)	cable	-
ID18N3E1L	NPN/NO+NC	5mm	1	brass(chrome plated)	cable	LED
ID18N3E1C	NPN/NO+NC	5mm	3	brass(chrome plated)	coupling	-
ID18N3E1CL	NPN/NO+NC	5mm	3	brass(chrome plated)	coupling	LED
ID18N3ES1	NPN/NO+NC	5mm	2	brass(chrome plated)	cable	-
ID18N3ES1L	NPN/NO+NC	5mm	2	brass(chrome plated)	cable	LED
ID18N31	NPN/NO+NC	7mm	4	brass(chrome plated)	cable	-
ID18N31L	NPN/NO+NC	7mm	4	brass(chrome plated)	cable	LED
ID18N31C	NPN/NO+NC	7mm	6	brass(chrome plated)	coupling	-
ID18N31CL	NPN/NO+NC	7mm	6	brass(chrome plated)	coupling	LED
ID18N32	NPN/NO+NC	7mm	4	PVC	cable	-
ID18N32L	NPN/NO+NC	7mm	4	PVC	cable	LED
ID18N32C	NPN/NO+NC	7mm	6	PVC	coupling	-
ID18N32CL	NPN/NO+NC	7mm	6	PVC	coupling	LED
ID18N3S1	NPN/NO+NC	7mm	5	brass(chrome plated)	cable	-
ID18N3S1L	NPN/NO+NC	7mm	5	brass(chrome plated)	cable	LED
ID18N3S2	NPN/NO+NC	7mm	5	PVC	cable	-
ID18N3S2L	NPN/NO+NC	7mm	5	PVC	cable	LED

### Technical features

Supply voltage	10...30 V
Ripple	< 10%
No load current	< 25 mA
Maximum output current	200 mA
Maximum commutation frequency	800 Hz
Detecting distance tolerance	±10% Sn
Hysteresis	10% Sn
Repeatability	<5% Sn
Ambient temperature (operating)	-10...+70°C
Degree of protection	IP67
Vibration resistance	10...55 Hz , amplitude 0,35mm
Shock resistance	98m/s <sup>2</sup> (10g)

**HOUSING**

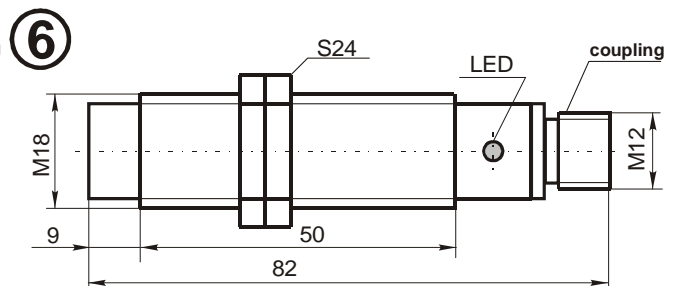
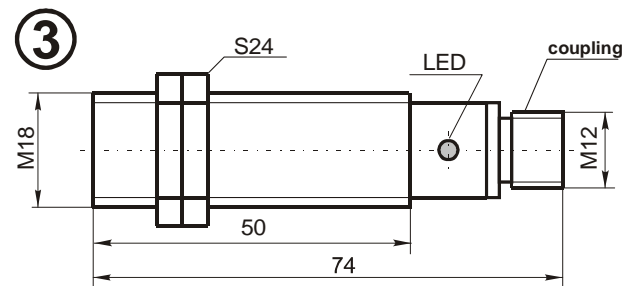
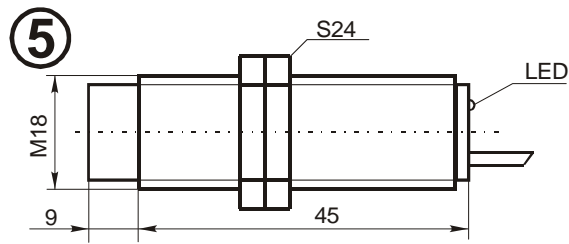
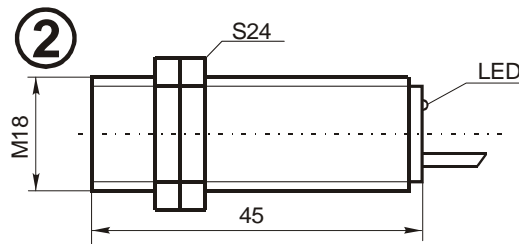
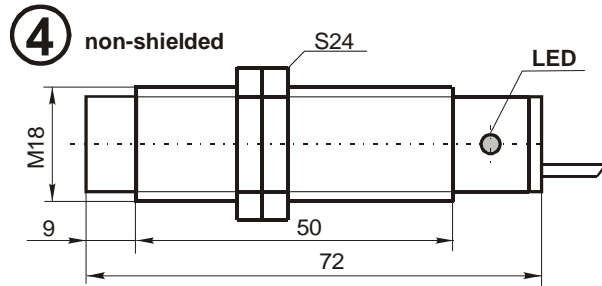
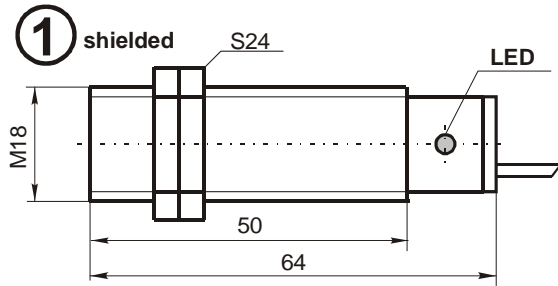

**Connection circuits**

