

Twilight switch LUMANDAR 1000

Solar cell technology

CHARACTERISTICS

- Accurate and durable, thus conserving energy
- Half a million units sold since 1954.

APPLICATIONS

Public area lighting :

- streets,
- parking lots,
- underground walkways, train platforms.



DESCRIPTION

LUMANDAR is the reference in twilight switches:

Its patented solar cell technology is as sensitive as the human eye. LUMANDAR switches on public lighting only when necessary: energy conservation.

Its 4 Lux sensitivity is designed for public lighting; it switches light only when required for the human eye.

Solar cell technology is durable. For years, your lighting will be always activated at the same moment, and with the same degree of precision.

Easy to install and wire; well sealed, it is made for outdoor installation and can be installed anywhere.

Self-contained with relay output, no accessories are required.

⚠ WARNING **PERSONAL INJURY**

DO NOT USE these products as safety or emergency stop devices, or in any other application where failure of the product could result in personal injury.

Failure to comply with these instructions could result in death or serious injury.

MECHANICAL DIMENSIONS (mm/in)

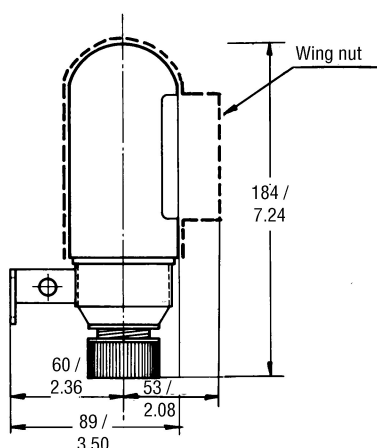
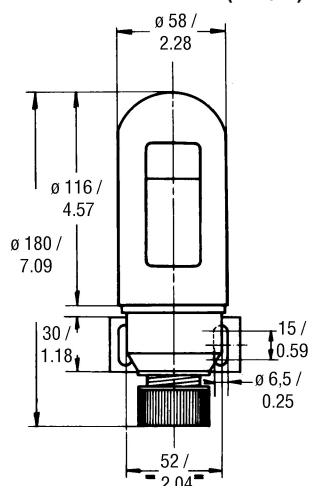



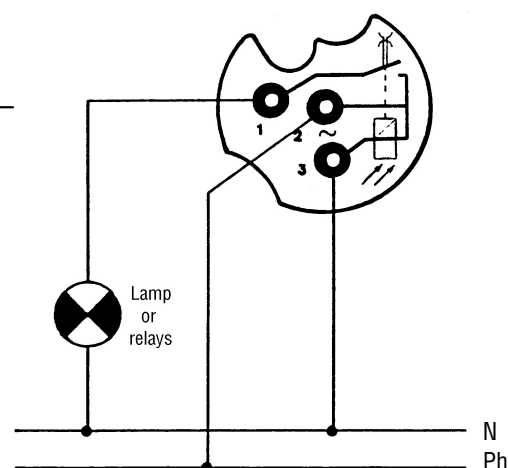



WIRING SPECIFICATIONS



TECHNICAL SPECIFICATIONS

Orientation	360°
Preset sensitivity	4 Lux, 50 Lux, 100 Lux
Protection	Sealing IP 67 + special version also available
Input voltage	24-48 V Vac or Vdc $\pm 15\%$ • 127-240 V Vac or Vdc $\pm 15\%$
Frequency	50 Hz or 60 Hz
Consumption	1,5 VA
Time Delay	3 s Ref LUANXXXX 30 s Ref LUATXXXX
Hysteresis	12 %
Switching capacity	10 A for 250 V on a resistive load 8 A Cos $\varphi = 0,85$ 6 A Cos $\varphi = 0,6$
Maximum power	2 200 VA
Weight	Complete product 300 g / 0.66 lbs
Operating temperature	from -30°C to 70°C / from -22°F to 158°F

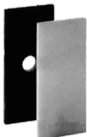
ORDERING INFORMATION

Reference		Description	Reference	Description
STANDARD		FF-LUA□44R□ FF-LUAN44RH FF-LUAN44RC FF-LUAN44RD FF-LUAT44RH		FF-LUAN74RO FF-LUAN75RO FF-LUAN71RO FF-LUAT74RO 24-48 V low voltage model Replace the number 7 with 6 (e.g. FF-LUAN74RO becomes FF-LUAN64RO) for the LUMANDAR only.
		Standard complete 4 Lux (contact closed by night) with attachment. 220/240 Vac 24 Vdc 48 Vdc Standard models Model with 30 s time delay on/off		LUMANDAR only – 4 Lux LUMANDAR only – 50 Lux LUMANDAR only – 100 Lux LUMANDAR only – 4 Lux Time delayed 30 s
		FF-LUZSE851		FF-LUZSE17□ Support for Vac or Vdc current (with locking screw) □ = C = 24 V □ = F = 110/127 V □ = H = 220/240 V □ = D = 48 V
		FF-LUZFA800 FF-LUZFA801		FF-LUZSE020 Attachment with screw or circular collar
ACCESSORIES		FF-LUZSE021		
		Adjustable wing nut. Reduces the effects of the lateral light interference. By rotating the cover, the nominal value is multiplied by 8.		
		Attenuation kit with 4 different values. Use with the FF-LUZSE851 wing nut. . The sensitivity thresholds are multiplied by 25, 50, 150, 300 (the 100 Lux base model should be used). . The sensitivity thresholds are multiplied by 20, 80, 100, 200.		
		14 mm / 0.5 in eye rod threaded to 230 mm / 9 in.		

In bold, preferred models – on stock

WARRANTY/REMEDY

Honeywell warrants goods of its manufacture as being free of defective materials and faulty workmanship. Contact your local sales office for warranty information. If warranted goods are returned to Honeywell during the period of coverage, Honeywell will repair or replace without charge those items it finds defective. The foregoing is Buyer's sole remedy and is **in lieu of all other warranties, expressed or implied, including those of merchantability and fitness for a particular purpose.**

Specifications may change without notice. The information we supply is believed to be accurate and reliable as of this printing. However, we assume no responsibility for its use.

While we provide application assistance personally, through our literature and the Honeywell web site, it is up to the customer to determine the suitability of the product in the application.

Honeywell Technical Assistance : 33 (0) 4 76 41 72 33

"Due to changes in standards and materials, we are not bound by the specifications and images contained within this document until confirmed by Technical Assistance."

© 1999-2004 - Honeywell International Inc. All rights reserved.

Honeywell

21 Chemin du Vieux Chêne – BP 81

F - 38240 Meylan Cedex

Tel : (33) 04 76 41 72 33

Fax: (33) 04 76 41 72 57

ISO 9001:2000



Certificate No. CC1816-025033