

## **MXO TOOL FRAME**

**New part of MULTIBEX family is an open tool frame which accomodates all MX die sets with an option for crimping butt connectors**

### **MULTIBEX hand tools for the application of**

**Insulated terminals**

**Non insulated terminals**

**End sleeves**

**Tab connectors**

**Coaxial connectors**

**Fiber optic connectors**

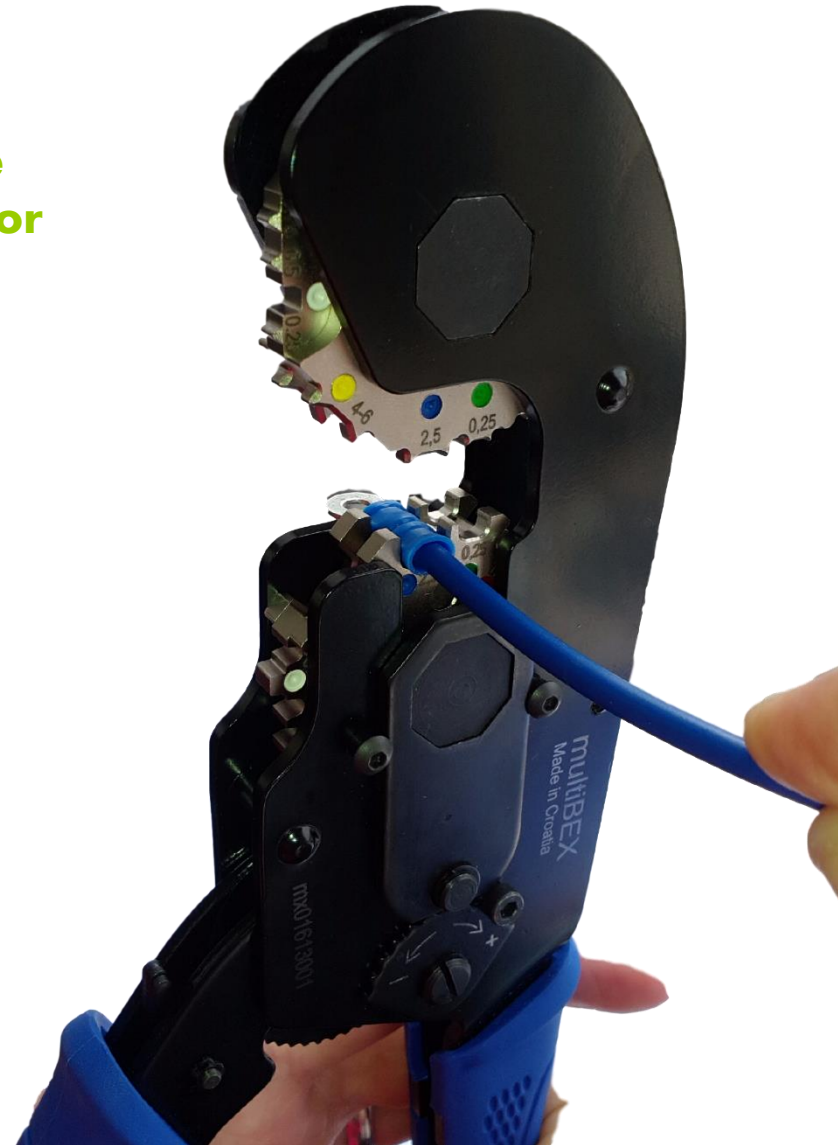

## TECHNICAL DATA

- ⇒ Type: Multibex tool frame MX0
- ⇒ Length [243 mm]
- ⇒ Width [56 mm]
- ⇒ Weight [678 g]
- ⇒ Max. Handle force: 5Kn
- ⇒ Life Span: 50 000 crimp cycles

## FEATURES

- ⇒ Easy achievement of high crimping force
- ⇒ Sure achievement of full crimping range and depth
- ⇒ Metal parts made of quality steel
- ⇒ Precise and quality manufacturing
- ⇒ Possibility of crimping force regulation and height of crimped contacts via eccentric axl
- ⇒ Safety relief

