

1

2

3

4

5

6

7

8

A

B

C

D

E

F

G

H

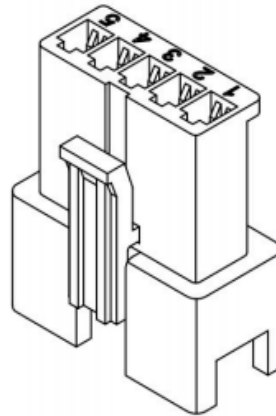
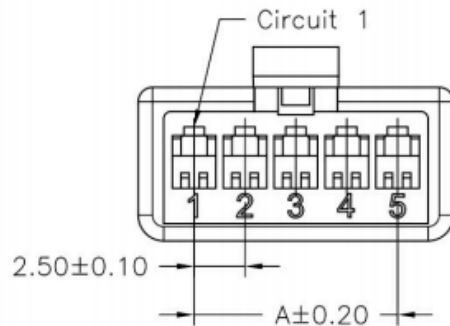

### SPECIFICATIONS

Current Rating: 3A AC,DC

Voltage Rating: 250V AC,DC

Temperature Range:  $-25^{\circ}\text{C} \sim +85^{\circ}\text{C}$

Contact Resistance:  $10\text{m}\Omega$  Max

Insulation Resistance:  $500\text{M}\Omega$  Min

Withstanding Voltage: 1500V AC/minute

Material: Nylon 66,UL94V-0

Color: Black

A

B

C

D

E

F

G

H

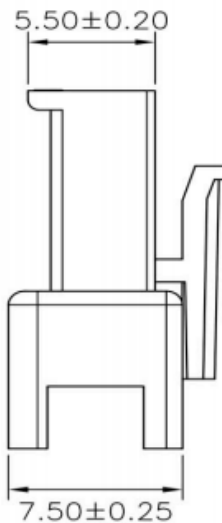
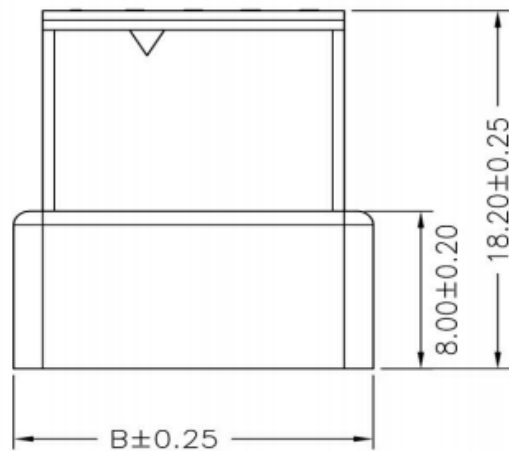

### Ordering Information & Dimensions

PART NO.	Dimensions	
	A	B
02P	2.50	8.00
03P	5.00	10.50
04P	7.50	13.00
05P	10.00	15.50
06P	12.50	18.00
07P	15.00	20.50
08P	17.50	23.00
09P	20.00	25.50
10P	22.50	28.00
11P	25.00	30.50
12P	27.50	33.00

1

2

3

4

5

6

7

8