

A

B

C

D

E

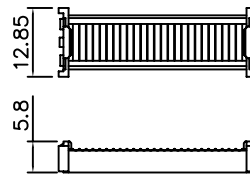
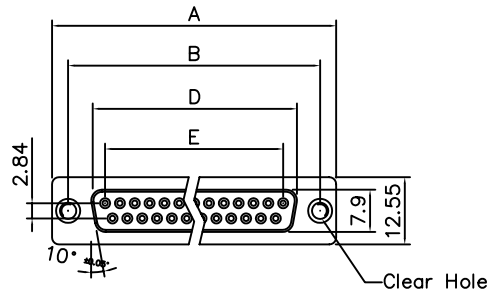

Cover

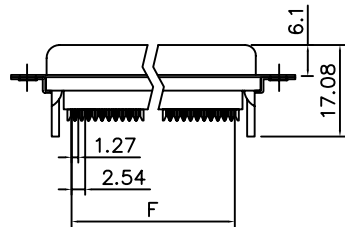

Without Insulator Support

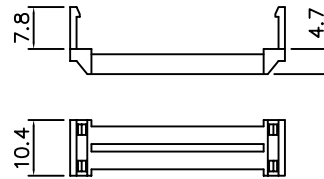
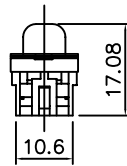

Strain Relief

## Dimensions

Positions	A	B	D	E	F
L17DEFRB09S	30.81	24.99	16.33	11.08	10.16
L17DAFRB15S	39.14	33.32	24.66	19.39	17.78
L17DBFRB25S	53.04	47.04	38.38	33.24	30.48
L17DCFRB37S	69.32	63.50	54.84	49.86	45.72



## TECHNICAL DATA

## D-SUBMINIATURE CONNECTORS

## Product Specification

## Material

Insulator : Glass-Filled Thermoplastic PBT, UL94V-0

Contact : Copper alloy

## Electrical

Contact Resistance : 20 milliohms  
Max at 3 AMP DC.Insulation Resistance : 1000  
megohms at 500 VDCDielectric Withstanding Voltage :  
1000 VAC/rms 60Hz for 1 minute

Current Rating : 3 AMP

Voltage Rating : 250 VAC/rms 60Hz

## PRODUCT CODE

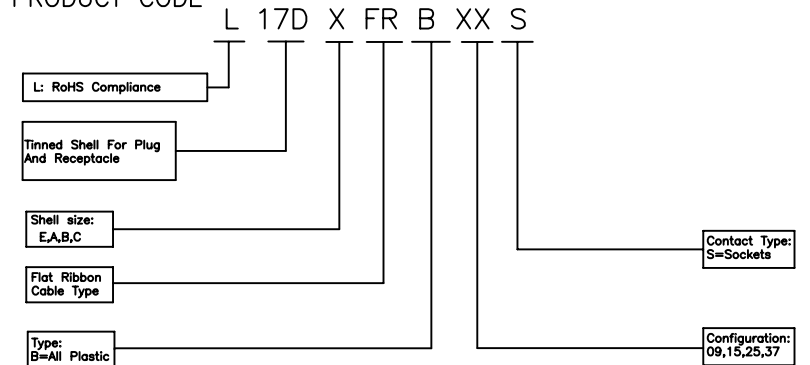

Amphenol

TOL. GEN.: +/-0.30

VOLUME:

AREA:

PLATING:

SERIES

NUMBER SERIES

IDC Series



TREATMENT:

MATERIAL:

DATE

2006.12.11

DESIGNATION

IDC Connector For Female  
All Plastic

PART NUMBER

L17DXFRBXXS

origin drawing

Roger

12/11/06

Terry

A

CUSTOMER MODIFICATIONS

DRAW

DATE

APPROVE

IND.