

This document is the property of Amphenol Corporation and is delivered on a non-exclusive basis. It is to be used for manufacturing or sale by anyone other than Amphenol Corporation. No part of this document may be reproduced, stored in a retrieval system, or to use any information in this document.

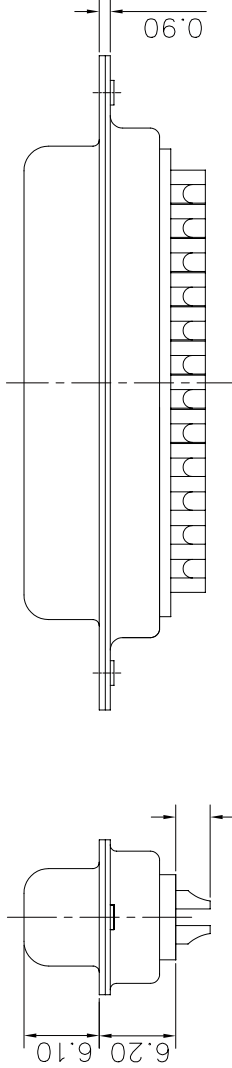
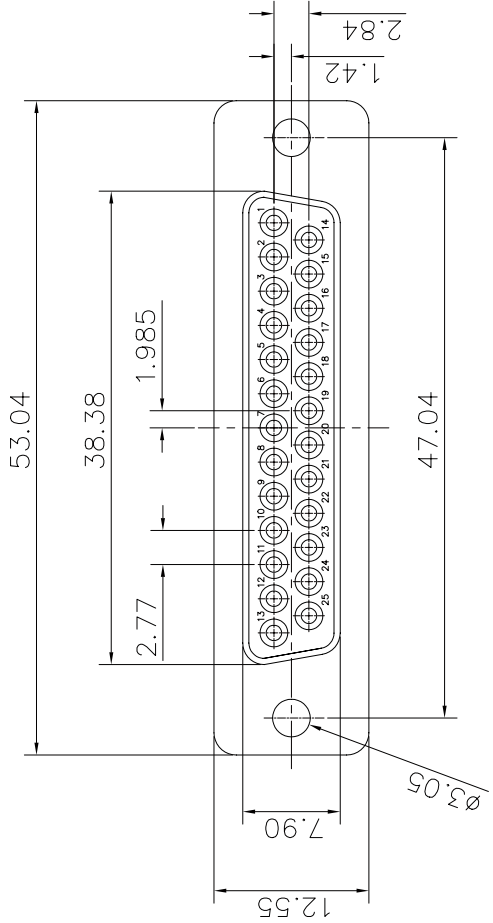

REVISIONS			
SYM	ECN	DESCRIPTION	DATE
A			15/01/07

D-SUB TECHNICAL DATA

SHELL :Steel, 100u" min. sn over 50u" min. nickel.
 BODY : Glass filled thermoplastic.
 Flame retardant to UL94 V-0 Color Black
 CONTACTS :phosphor bronze
 gold flash over 1.25um(50u") min nickel on mating area
 2.5um(100u") min sn over 1.25um(50u") min nickel on solder area
 ELECTRICAL : Voltage rating : 250 V RMS at 50 Hz
 Current rating :3A
 Withstanding Voltage >1000 V Rms to 60 Hz for one minute
 Insulation resistance >5000 M Ohms
 Contact resistance 20 mOhms max.
 CLIMATIC : Temperature range -55 °C up to 125°C
 MACHANICAL : Insertion force per contact 3.41N Max..
 Extraction force per contact 0.21N Min..
 MARKING : Amphenol...(Series No.)
 Commercial reference
 Manufacturing date
 tamppography marking

PRODUCT CODE

L 77SD B 25 S

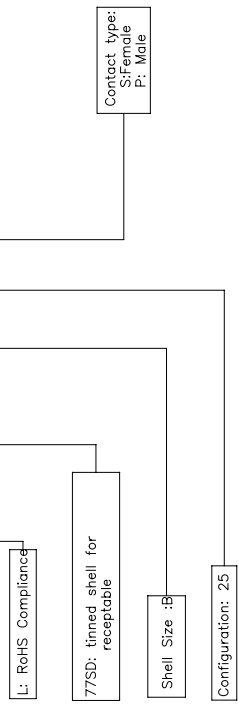

UNLESS OTHERWISE SPECIFIED		APPROVAL		DATE	
TOLERANCES	METRIC	DRAWN	HELEN.JIANG/03/07	CHECKED	LIKUANG/07/03/07
X +/-	0.50				
.XX +/-	0.30				
.XXX +/-	0.20				
FRACTIONS					
ANGLES	2°				
FOR MATERIALS AND FINISHES SEE TABLES					
REMOVE SHARP EDGES					
DIMENSIONS					
INCHES					
MM					
DRAWING FILE :					
ANGLE OF PROJECTION					
TITLE					
Amphenol					
Stamped and Formed connector, SD series					
SIZE	DRAWING NO.		REV.		
A4	C L77SD B25S		A		
SCALE	NONE		SHEET 1 OF 1		