

ORDERING CODE: **MRJR-938X-XC**

SERIES, RUGGED RJ

CAT6A RJ45 RECEPTACLE,
RIGHT ANGLE PCB TAIL,
8 CONTACTS

LED OPTION:
0 = NONE

1 = GREEN LEFT, YELLOW RIGHT
4 = YELLOW LEFT, GREEN RIGHT
5 = GREEN LEFT, GREEN RIGHT
7 = RED LEFT, GREEN RIGHT
A = BI-COLOUR GREEN/YELLOW LEFT
BI-COLOUR GREEN/YELLOW RIGHT
D = GREEN LEFT
BI-COLOUR GREEN/YELLOW RIGHT
E = YELLOW LEFT
BI-COLOUR GREEN/YELLOW RIGHT

TAIL LENGTH AND MOUNTING
HOLE THREAD OPTION:

0 = "A" 2.54 [100], #4-40 UNC
B = "A" 3.81 [150], #4-40 UNC
M = "A" 2.54 [100], M3 X 0.5
P = "A" 3.81 [150], M3 X 0.5

SINGLE PORT, EXTRA CLEARANCE
NEAR SHELL MOUNTING HOLES

SPECIAL CONNECTORS

MANY UNIQUE FEATURES ARE READILY
AVAILABLE TO SUIT CUSTOMER
REQUIREMENTS. CONSULT WITH
AMPHENOL CANADA FOR DETAILS.



NOTES:

- MATERIALS: ALL MATERIALS ARE RoHS COMPLIANT PER EU DIRECTIVE 2011/65/EU AND AMENDMENTS
 - SHELL - DIECAST ZINC, NICKEL PLATED
 - CONTACTS - PHOSPHOR BRONZE WITH 1.27µm [50 µ"] MIN GOLD OVER 1.27µm [50 µ"] MIN NICKEL ON THE MATING AREA AND MATTE TIN OVER NICKEL ON THE CONTACT TAILS.
 - INSERTS - ENGINEERING THERMOPLASTIC, UL94V-0 FLAMMABILITY RATING, REAR INSERTS: BLACK NYLON, FRONT INSERT: CLEAR POLYCARBONATE
 - GASKET - SILICONE RUBBER, CONDUCTIVE, BLACK
 - LED'S - EPOXY LENS, STEEL TAILS WITH TIN PLATING
 - PCB - FR-4 FIBERGLASS, LEAD FREE, UL94V-0 FLAMMABILITY RATING
- ENVIRONMENTAL PERFORMANCE PER IEC 60529 CODE IP67 FOR SEAL BETWEEN MATING AREA AND PCB SIDE OF CONNECTOR. GASKET PROVIDES SEAL TO INSIDE FACE OF PANEL.
- CURRENT RATING: 1.25 AMPERES
- CONTACT RESISTANCE: 30 MILLIOHMS MAXIMUM
- OPERATING TEMPERATURE: -40C TO +105C
- LED CHARACTERISTICS: FORWARD DC CURRENT 25 mA MAX.
FORWARD VOLTAGE 2.5V MAX.@ 2 mA
- RECOMMENDED TORQUE FOR PANEL MOUNT SCREWS: 0.45 TO 0.65 N-m (4.0 TO 5.75 IN-LBS) FOR STEEL SCREWS WITH 3.00 (.118) THREAD ENGAGEMENT.
- CUSTOMER TO VERIFY THAT ALL PROCESS CLEANERS ARE COMPATIBLE WITH POLYCARBONATE MATERIAL.
- AVAILABLE MATING AREA COVERS PROVIDE ADDED PROTECTION. CONSULT WITH AMPHENOL CANADA FOR MORE DETAILS.
- COMPARED TO DRAWING P-MRJR-53XX-X1, PARTS ON THIS DRAWING HAVE EXTRA CLEARANCE NEAR THE SHELL MOUNTING HOLES (2 PLCS).

REVISIONS			
REV	DESCRIPTION, ECN, EAR NO.	DATE	APP'D
B	PRODUCT DRAWING (EAR 14655)	OCT26/18	K.L.
C	PRODUCT DRAWING (EAR 14655)	NOV21/18	K.L.

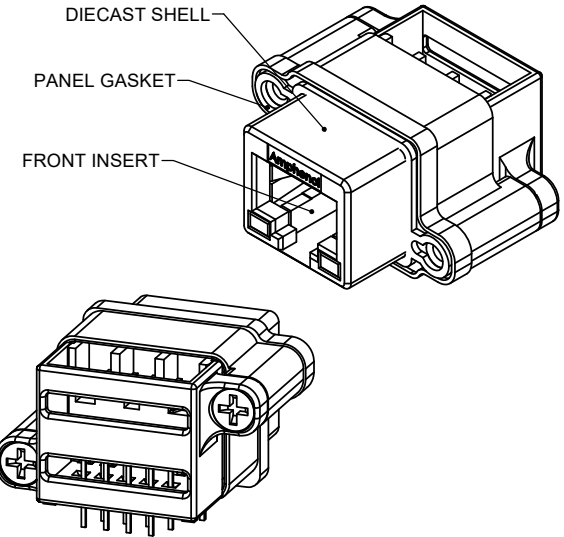

UNLESS SPECIFIED OTHERWISE	DRAWN	M. PAHULJE	MAR27/18
PRIMARY UNITS MILLIMETERS	CHECKED	K. LAMBIE	MAY24/18
SECONDARY INCHES	M.E. APP'D		
REFERENCE IN PARENTHESES	Q.A. APP'D		
GENERAL TOLERANCES	DWG APPR.		
1 DECIMAL PLACE	ENG. REL. NO.	EAR 14655	
2 DECIMAL PLACES ±0.15	REF.		
3 DECIMAL PLACES	THIRD ANGLE PROJECTION		
ANGULAR DEGREES			

Amphenol Canada Corp. Commercial Products			
MRJR SERIES RUGGED CAT6A MODULAR JACK, RIGHT ANGLE, 8 CONTACTS, LED, TAIL LENGTH, & THREAD OPTIONS, EXTRA SHELL CLEARANCE, ROHS COMPLIANT			
P-MRJR-938X-XC			REV C
CODE ID NO. 03554	DWG SIZE: X	SCALE: 3:1	SHEET 1 OF 2

REVISIONS			
REV	DESCRIPTION, ECN, EAR NO.	DATE	APP'D
B	PRODUCT DRAWING (EAR 14655)	OCT26/18	K.L.
C	PRODUCT DRAWING (EAR 14655)	NOV21/18	K.L.

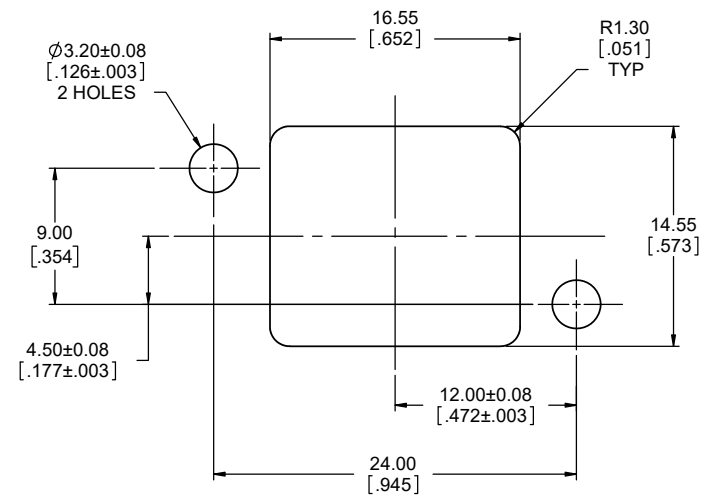
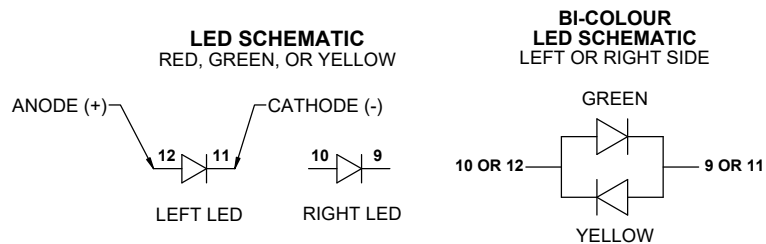
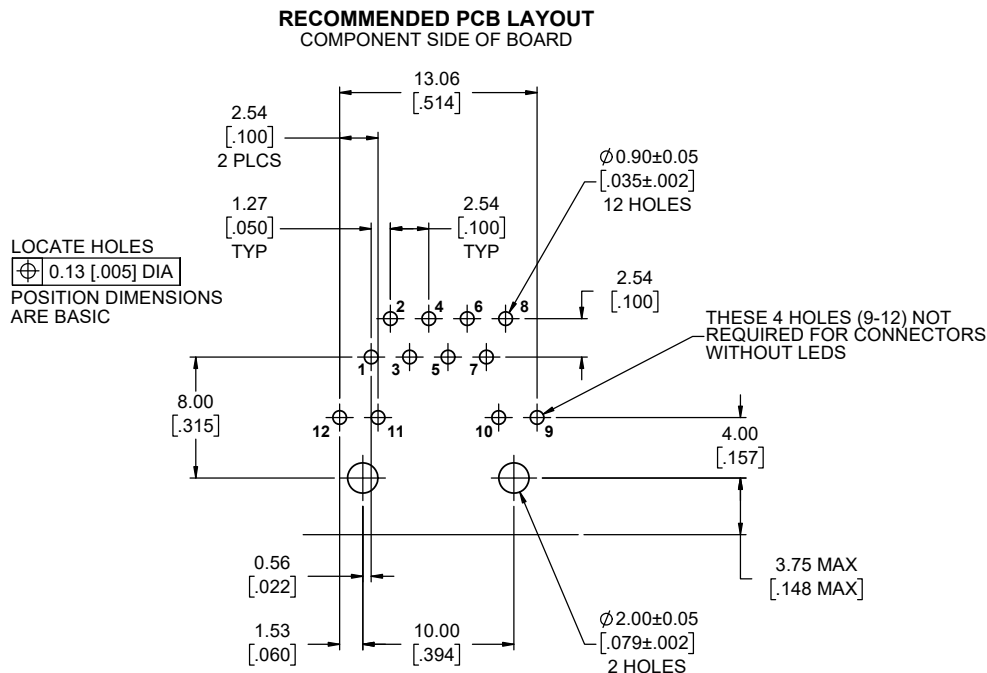

RECOMMENDED PANEL CUTOUT
OUTSIDE PANEL VIEW

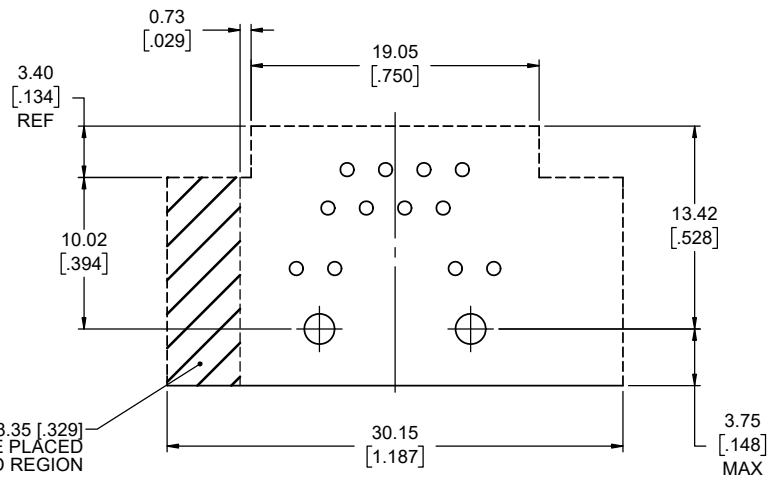

RECOMMENDED KEEP-OUT ZONE
COMPONENT SIDE OF BOARD



UNLESS SPECIFIED OTHERWISE	DRAWN	M. PAHULJE	MAR27/18
PRIMARY UNITS MILLIMETERS	CHECKED	K. LAMBIE	MAY24/18
SECONDARY INCHES	M.E. APP'D		
REFERENCE IN PARENTHESES	Q.A. APP'D		
GENERAL TOLERANCES	DWG APPR.		
1 DECIMAL PLACE	ENG. REL. NO.	EAR 14655	
2 DECIMAL PLACES ± 0.15	REF.		
3 DECIMAL PLACES	THIRD ANGLE PROJECTION		
ANGULAR DEGREES			

Amphenol Canada Corp. Commercial Products			
MRJR SERIES RUGGED CAT6A MODULAR JACK, RIGHT ANGLE, 8 CONTACTS, LED, TAIL LENGTH, & THREAD OPTIONS, EXTRA SHELL CLEARANCE, ROHS COMPLIANT			
DWG. NO.	P-MRJR-938X-XC		
CODE ID NO. 03554	DWG. SIZE: X	SCALE: 5:1	SHEET 2 OF 2