

**Valena™ Life - Valena™ INMATIC**  
**Cat. 5e RJ45 sockets**

**Cat. No(s): 7 530 40/41 - 7 531 40/41/53/54 - 7 532 40/41/53/54  
 7 533 40/41/53/54 - 7 563 40/61/53/54**

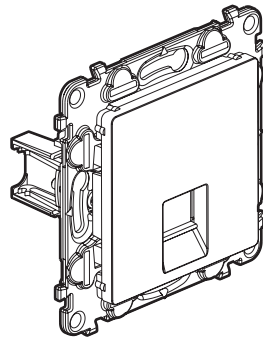

7 531 40

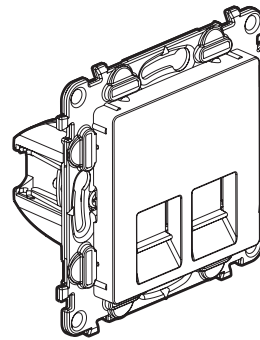

7 531 41

**1. USE**

Category 5e RJ45 sockets.  
 Allow high-speed transmissions (Gigabit Ethernet).  
 Can be flush mounted in a box min. 40 mm deep.  
 To be equipped with plate.

**2. RANGE**

UTP Cat. 5e RJ45 - claw fixing Mechanism + cover plate				Mechanism only
White	Ivory	Aluminium	Black	
7 531 40	7 532 40	7 533 40	7 563 40	7 530 40
Double UTP Cat. 5e RJ45 - claw fixing Mechanism + cover plate				Mechanism only
White	Ivory	Aluminium	Black	
7 531 41	7 532 41	7 533 41	7 563 61	7 530 41
FTP Cat. 5e RJ45 - claw fixing Mechanism + cover plate				Mechanism only
White	Ivory	Aluminium	Black	
7 531 53	7 532 53	7 533 53	7 563 53	-
Double FTP Cat. 5e RJ45 - claw fixing Mechanism + cover plate				Mechanism only
White	Ivory	Aluminium	Black	
7 531 54	7 532 54	7 533 54	7 563 54	-

**3. PRESENTATION**

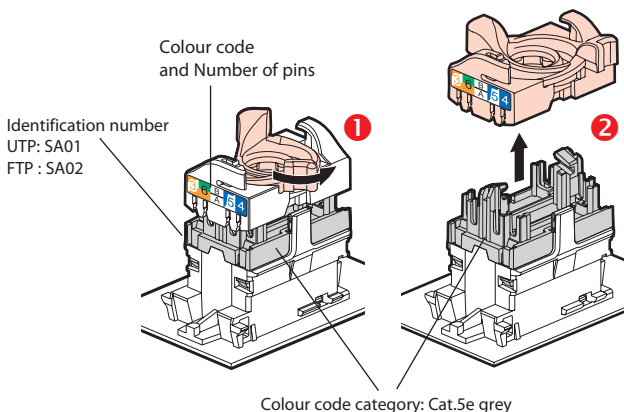

**4. DIMENSIONS (mm)**

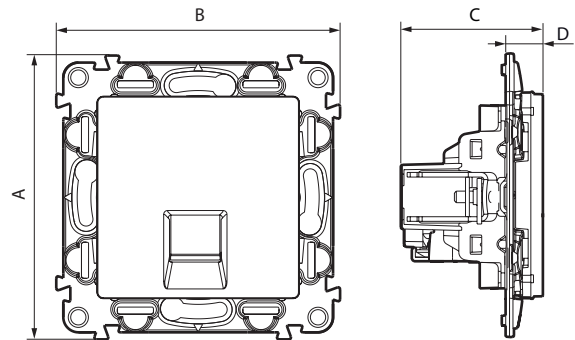

Cat. Nos	A	B	C	D
7 531 40/41/53/54 - 7 532 40/41/53/54 7 533 40/41/53/54 - 7 563 40/53/54 - 7 563 61	75	75	37	10
7 530 40/41	75	75	35	8

**5. STANDARD RJ45 CONNECTION**

Takes the following plugs: RJ45 (8 contacts).  
 T568A and T568B dual colour code on terminals: UTP (8 contacts)  
 FTP (9 contacts)

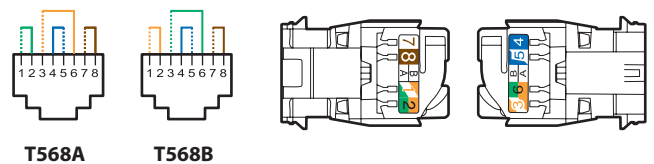

Conductors supported:  
 Single core/Multicore: 0.4 to 0.65 mm, AWG 22 up to AWG 26  
 Polyethylene conductor insulation: Ø on insulation 0.85 to 1.7 mm

## 5. STANDARD RJ45 CONNECTION (continued)

RJ45 connectors are equipped with a locking nut. They do not require a special tool and can be re-wired if a mistake is made.

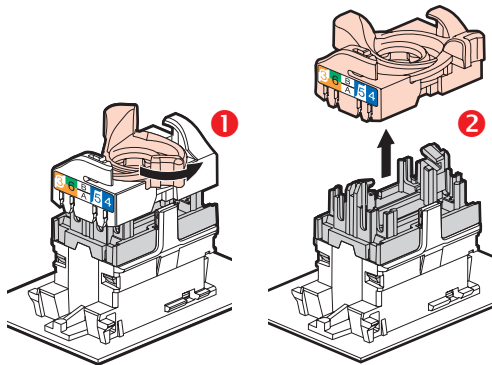

This system makes it easy to spread pairs before fitting them onto the connector.

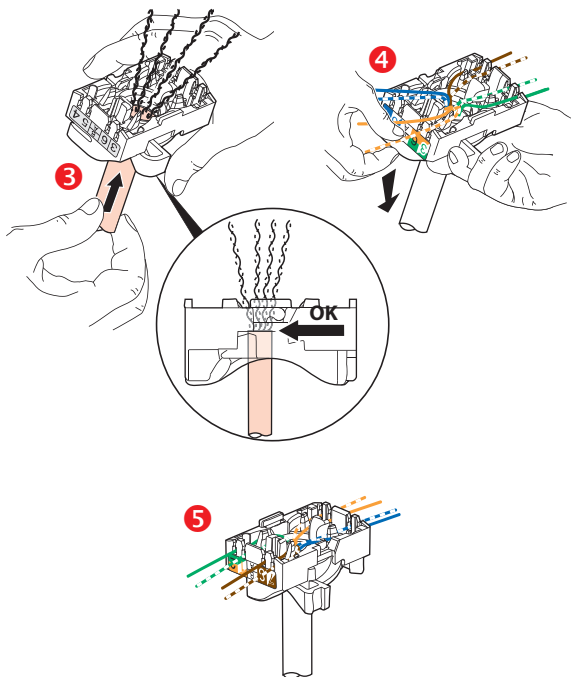

Spreading the cables ensures that a pair-breakage distance of 13 mm is kept between each pair.  
Spreading pairs at 90° to the cable ensures the best possible performance.

## 6. TECHNICAL CHARACTERISTICS

### ■ 6.1 Mechanical characteristics

Protection against impacts: IK 03  
Protection against solid/bodies and liquids: IP 20  
Maximum number of connections and disconnections: 5 without replacing the wire.  
Endurance: 2500 operations (plugging in/unplugging).

### ■ 6.2 Material characteristics

- Cover plate: White ABS RAL 9003  
Ivory ABS RAL 1013  
Painted ABS Aluminium and Black

Halogen-free  
UV-resistant

- Motor: Contacts: gold/nickel, thickness of gold > 0.8 µm minimum  
Metal parts: bronze, nickel, platinum, gold  
Polycarbonate PBT

Self-extinguishing:

850°C/30 s for insulating components holding live parts in place  
650°C/30 s for other insulating components

### ■ 6.3 Caractéristiques électriques

Breakdown voltage 1000 VDC  
Contact resistance 20 mΩ  
Insulation resistance 500 mΩ at 100 VDC  
Tested and independently certified to comply with IEC 60512-99-001 and IEC 60512-99-002 for PoE support up to 90 W (Type 4).

### ■ 6.4 Climate characteristics

Storage temperature: -10°C to +70°C  
Usage temperature: -10°C to +60°C

## 7. CLEANING

Surface cleaning with a cloth.

Do not use acetone, tar remover, trichloroethylene.

Resistant to the following products: Hexane (NF C 61-314), Methylated spirit, soapy water, diluted ammonia, bleach diluted to 10 %, window-cleaning products, pre-impregnated wipes.

**Caution:** Always test before using special cleaning products.

## 8. STANDARDS AND APPROVALS

Connectors are compliant to requirements for the following remote powering applications IEEE 802.3 af, IEEE 802.3at, IEEE 802.3bt: "Power over Ethernet", Type 1 to 4, up to 90 W.

Compliant with installation and manufacturing standards.  
See e-catalogue.

**9. PERFORMANCE**

■ **9.1 Performance of components (RJ 45 connectors)**  
 Return loss

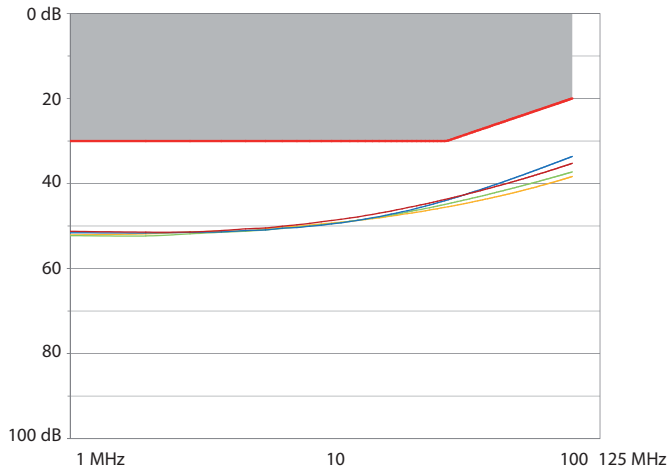

Attenuation

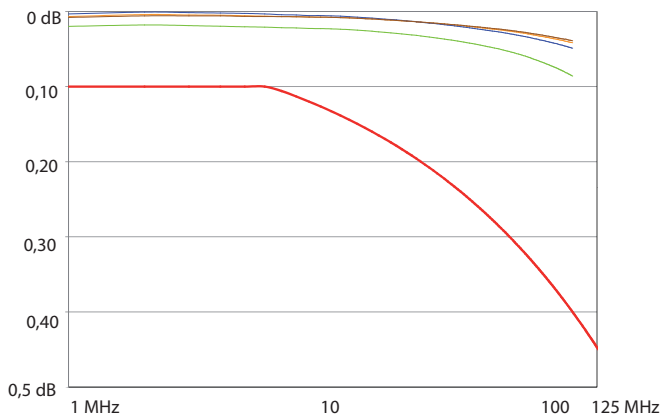

NEXT (Near end Crosstalk Attenuation)

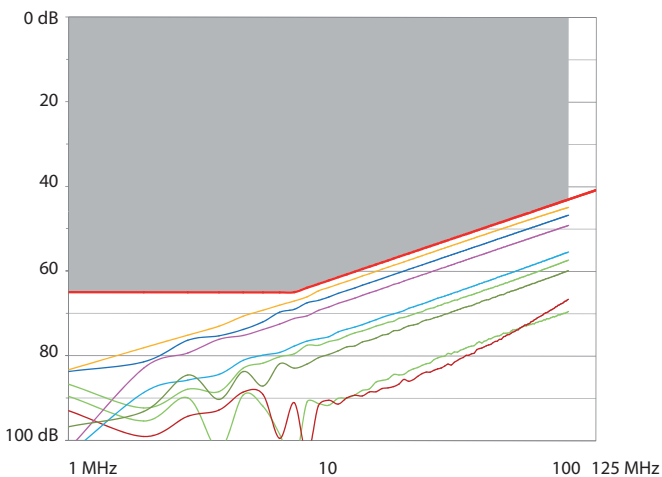

**9. PERFORMANCE**

■ **9.1 Performance of components (RJ 45 connectors) (continued)**  
 FEXT (Far end Crosstalk Attenuation)

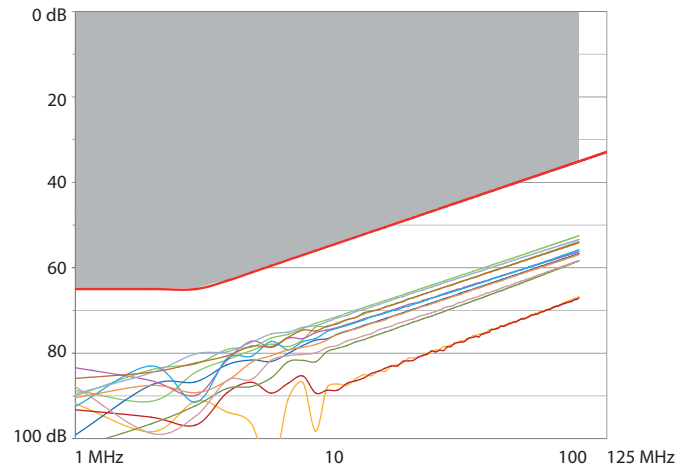

■ **9.2 Performance of permanent link with F/UTP cable**  
 Return loss

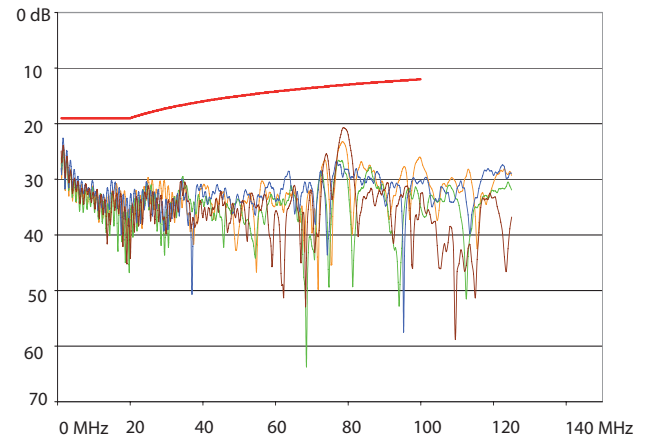

Attenuation

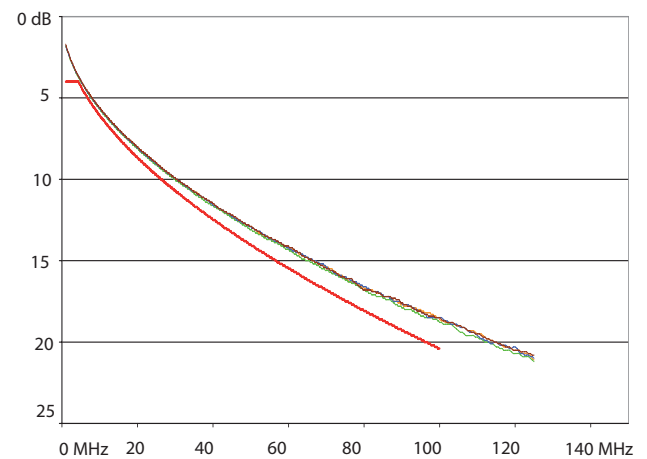

**9. PERFORMANCE** (continued)

■ **9.2 Performance of permanent link with F/UTP cable** (continued)  
 NEXT (Near end Crosstalk Attenuation)

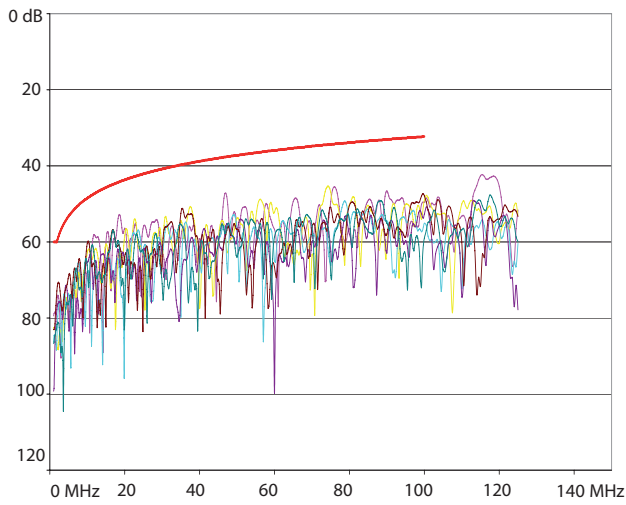

PS NEXT (Power Sum NEXT)

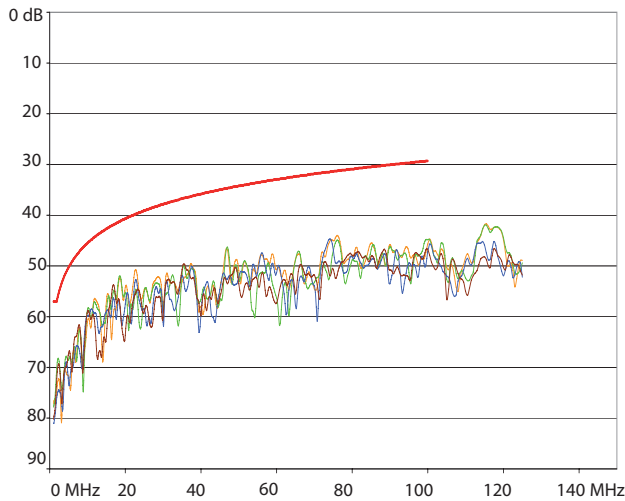

ACR (Attenuation to Crosstalk Ratio) (Ecart paradiaphonique)

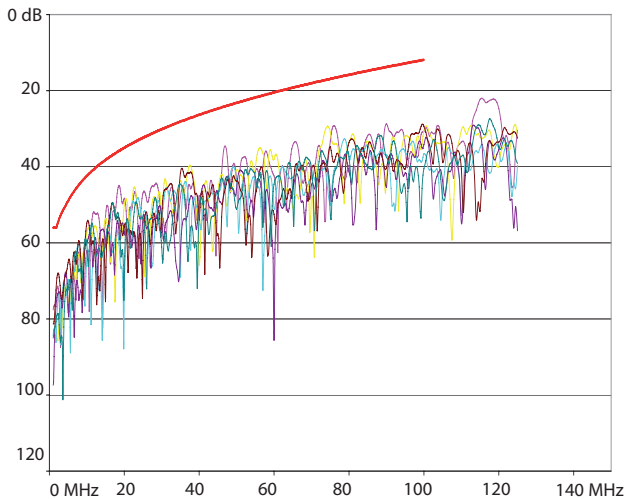

**9. PERFORMANCE** (continued)

■ **9.2 Performance of permanent link with F/UTP cable** (continued)  
 ELFEXT (Equal Level End Crosstalk Attenuation)

