



# PRESSACAVI

*CABLE-GLANDS*



## PRESSACAVI CERTIFICATI PER INSTALLAZIONI ELETTRICHE CERTIFIED CABLE GLANDS FOR ELECTRICAL INSTALLATIONS

Lamelle di tenuta che permettono un serraggio progressivo senza scatti e una notevole resistenza alla trazione/torsione del cavo.

*Sealing slots that allow for smooth progressive clamping and provide remarkable resistance to the cable's traction and twist.*

Corpo pressacavo con filettatura ideata per assicurare un'eccellente tenuta meccanica e impedire svitamenti accidentali.

*Cable gland with a thread design engineered to ensure excellent mechanical sealing and prevent accidental unscrewing.*

### PRESSACAVO CON FLANGIA PASSO PG IP68

*CABLE GLAND WITH FLANGE  
PG THREAD IP68*

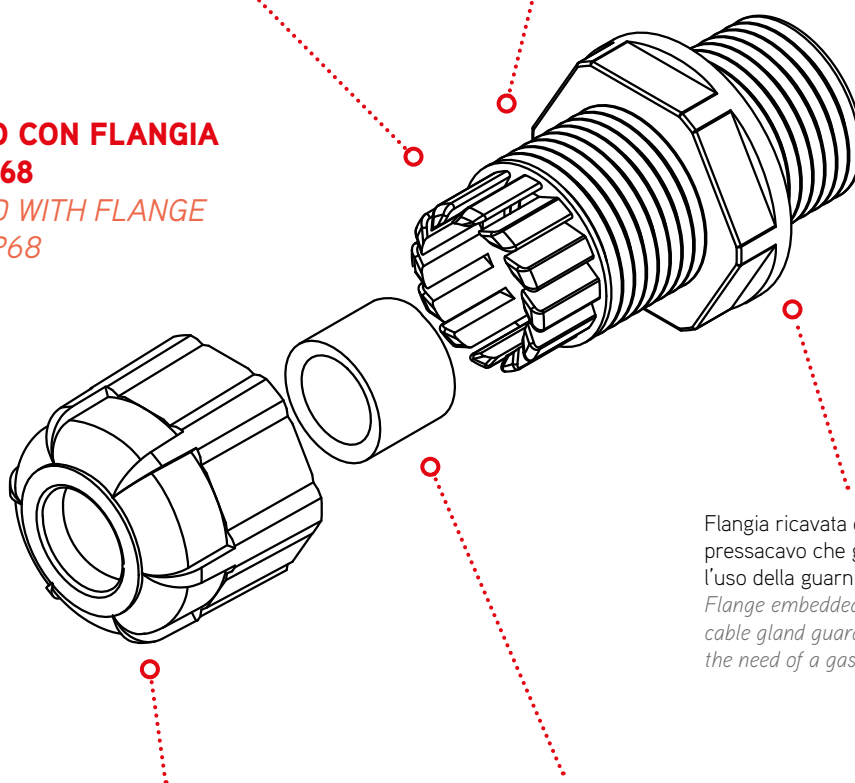

Testina con esagono rinforzato che permette un facile e sicuro avvvitamento.

*Pressure-screw with strengthened hexagon that allows easy and secure screwing.*

Flangia ricavata direttamente sul corpo del pressacavo che garantisce la tenuta IP68 senza l'uso della guarnizione.

*Flange embedded directly on the body of the cable gland guaranteeing IP68 sealing without the need of a gasket.*

Guarnizione interna in gomma nitrilica che garantisce una perfetta tenuta IP68 sul cavo.

*Nitrile rubber inner gasket that guarantees perfect IP68 sealing on the cable.*



file n° E171361



file n° E171361



LR 44081-10

**IP68**

**Vai a pagina 192 per avere tutte le informazioni di questo prodotto.**

*Find detailed information about this product on page 192.*

# PRESSACAVI: CORRETTA INSTALLAZIONE

## CABLE GLANDS: CORRECT INSTALLATION

### DIAMETRO DEL FILETTO · DIAMETRO FORO DI INSTALLAZIONE

#### THREAD DIAMETER · INSTALLATION HOLE DIAMETER

#### FILETTO METRICO EN 60423 · METRIC THREAD EN 60423

		M 12x1,5	M 16x1,5	M 20x1,5	M 25x1,5	M 32x1,5	M 40x1,5	M 50x1,5	M 63x1,5
Diametro filetto Thread diam.	mm	12	16	20	25	32	40	50	63
Diametro foro Hole diameter	mm	12,5	16,5	20,5	25,5	32,5	40,5	50,5	63,5

#### FILETTO PG DIN 40430 · PG THREAD DIN 40430

		PG 7	PG 9	PG 11	PG 13,5	PG 16	PG 21	PG 29	PG 36	PG 42	PG 48
Diametro filetto Thread diam.	mm	12,5	15,2	18,6	20,4	22,5	28,3	37	47	54	59,3
Diametro foro Hole diameter	mm	13	15,5	19	21	23	28,5	37,5	47,5	54,5	60

#### FILETTO GAS ISO 228/1 · GAS THREAD ISO 228/1

		GAS					GAS 1			GAS 2		GAS 3	
		1/4	3/8	1/2	5/8	3/4	GAS 1	1/8	1/4	1/2	GAS 2	1/2	GAS 3
Diametro filetto Thread diam.	mm	13,2	16,7	21	22,9	26,4	33,3	37,9	41,9	47,8	59,6	75,2	87,9
Diametro foro Hole diameter	mm	13,5	17	21,5	23,5	27	33,5	38,5	42,5	48	60	75,5	88,5

### VALORE MINIMO DI COPPIA DI SERRAGGIO PER GARANTIRE LA PROTEZIONE IP68

#### MINIMUM TORQUE VALUE TO GUARANTEE IP68 PROTECTION

#### FILETTO METRICO EN 60423 · METRIC THREAD EN 60423

		M 12x1,5	M 16x1,5	M 20x1,5	M 25x1,5	M 32x1,5	M 40x1,5	M 50x1,5	M 63x1,5
Coppia di serraggio Head torque	newton metro (Nm)	2	2,5	5	6	7	10	11,5	12,5

#### FILETTO PG DIN 40430 · PG THREAD DIN 40430

		PG 7	PG 9	PG 11	PG 13,5	PG 16	PG 21	PG 29	PG 36	PG 42	PG 48
Coppia di serraggio Head torque	newton metro (Nm)	2,5	3,75	3,75	5	6	7	10	11,5	12,5	12,5

# PRESSACAVI IN NYLON · NYLON CABLE GLANDS

## CAPACITÀ DI SERRAGGIO · CLAMPING RANGE

### CAPACITÀ DI SERRAGGIO FILETTO METRICO IP68 · METRIC THREAD IP68 CLAMPING RANGE

Passo	3	4	5	6	7	8	9	10	11	12	13	14	15	16	17	18	19	20	21	22	23	24	25	26	27	28	29	30	31	32	33	34	35	36	37	38	39	40	41	42	43	44	45									
M12x1,5				3 - 6,5																																																
M16x1,5				4 - 8																																																
M20x1,5							6 - 12																																													
M25x1,5												13 - 18																																								
M32x1,5																16 - 21																																				
M40x1,5																																																				
M50x1,5																																																				
M63x1,5																																																				

### CAPACITÀ DI SERRAGGIO FILETTO PG IP68 (UL, CSA) · PG THREAD IP68 CLAMPING RANGE (UL, CSA)

Passo	3	4	5	6	7	8	9	10	11	12	13	14	15	16	17	18	19	20	21	22	23	24	25	26	27	28	29	30	31	32	33	34	35	36	37	38	39	40	41	42	43	44	45											
PG 7				3 - 6,5																																																		
PG 9				4 - 8																																																		
PG 11							5 - 10																																															
PG 13,5											6 - 12																																											
PG 16																																																						
PG 21																																																						
PG 29																																																						
PG 36																																																						

### CAPACITÀ DI SERRAGGIO FILETTO PG IP68 · PG THREAD IP68 CLAMPING RANGE

Passo	3	4	5	6	7	8	9	10	11	12	13	14	15	16	17	18	19	20	21	22	23	24	25	26	27	28	29	30	31	32	33	34	35	36	37	38	39	40	41	42	43	44	45												
PG 7				3 - 6,5																																																			
PG 9				4 - 8																																																			
PG 11							5 - 10																																																
PG 13,5											6 - 11																																												
PG 16																																																							
PG 21																																																							
PG 29																																																							
PG 36																																																							
PG 42																																																							
PG 48																																																							

### CAPACITÀ DI SERRAGGIO FILETTO PG IP54 · PG THREAD IP54 CLAMPING RANGE

Passo	3	4	5	6	7	8	9	10	11	12	13	14	15	16	17	18	19	20	21	22	23	24	25	26	27	28	29	30	31	32	33	34	35	36	37	38	39	40	41	42	43	44	45											
PG 7				3,5 - 6																																																		
PG 9				4,5 - 7																																																		
PG 11							6 - 9																																															
PG 13,5											9 - 12																																											
PG 16																																																						
PG 21																																																						
PG 29																																																						
PG 36																																																						
PG 42																																																						
PG 48																																																						

### CAPACITÀ DI SERRAGGIO FILETTO GAS IP54 · GAS THREAD IP54 CLAMPING RANGE

## PASSO METRICO METRIC THREAD

### PASSO METRICO · IP68 · STANDARD METRIC THREAD · IP68 · STANDARD

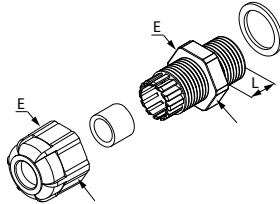

**MATERIALE:** poliammide (PA6.6), autoestinguente in accordo a: UL-94 - V2 e IEC 695-2-1 (850 °C)  
**TEMPERATURA D'ESERCIZIO:** da -20 °C a +90 °C  
**GUARNIZIONE INTERNA E RONDELLA:** NBR (gomma nitrilica), durezza 70 Shore A  
**NORME DI RIF.:** EN 62444:2013

**MATERIAL:** polyamide (PA6.6), self-extinguishing according to: UL-94 V2 and IEC 695-2-1 (850 °C)  
**OPERATING TEMPERATURE:** from -20 °C to +90 °C  
**INNER GASKET AND WASHER:** NBR (nitrile rubber), 70 Shore A hardness  
**ACCORDING TO STD.:** EN 62444:2013

Grigio RAL 7035 Grey RAL 7035	Nero RAL 9005 Black RAL 9005	Filetto Thread size	Diametro cavi Cable clamping range	Chiave Nut		
Articolo - Code	Articolo - Code	EN 60423	ø mm	L	E	
<b>4912</b>	<b>4912N</b>	M 12 x 1,5	3 - 6,5	9	16	50/250
<b>4917</b>	<b>4917N</b>	M 16 x 1,5	4 - 8	9	19	
<b>4920</b>	<b>4920N</b>	M 20 x 1,5	6 - 12	10	24	25/125
<b>4925</b>	<b>4925N</b>	M 25 x 1,5	13 - 18	12	33	
<b>4932</b>	<b>4932N</b>	M 32 x 1,5	16 - 21	12	36	20/100
<b>4940</b>	<b>4940N</b>	M 40 x 1,5	20 - 26	15	46	10/50
<b>4950</b>	<b>4950N</b>	M 50 x 1,5	32 - 38	18	60	5/25
<b>4963</b>	<b>4963N</b>	M 63 x 1,5	37 - 44	18	68	5/5

**IP68**

### PASSO METRICO · IP68 · CON DADO DI FISSAGGIO METRIC THREAD · IP68 · WITH LOCKNUT

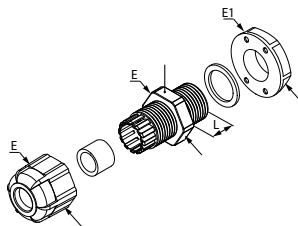

**MATERIALE:** poliammide (PA6.6), autoestinguente in accordo a: UL-94 - V2 e IEC 695-2-1 (850 °C)  
**DADO DI FISSAGGIO:** con flangia  
**TEMPERATURA D'ESERCIZIO:** da -20 °C a +90 °C  
**GUARNIZIONE INTERNA E RONDELLA:** NBR (gomma nitrilica), durezza 70 Shore A  
**NORME DI RIF.:** EN 62444:2013

**MATERIAL:** polyamide (PA6.6), self-extinguishing according to: UL-94 V2 and IEC 695-2-1 (850 °C)  
**LOCKNUT:** with flange  
**OPERATING TEMPERATURE:** from -20 °C to +90 °C  
**INNER GASKET AND WASHER:** NBR (nitrile rubber), 70 Shore A hardness  
**ACCORDING TO STD.:** EN 62444:2013

Grigio RAL 7035 Grey RAL 7035	Nero RAL 9005 Black RAL 9005	Filetto Thread size	Diametro cavi Cable clamping range	Chiave Nut	Chiave Locknut		
Articolo - Code	Articolo - Code	EN 60423	ø mm	L	E	E1	
<b>4712</b>	<b>4712N</b>	M 12 x 1,5	3 - 6,5	9	16	17	25/250
<b>4717</b>	<b>4717N</b>	M 16 x 1,5	4 - 8	9	19	22	
<b>4720</b>	<b>4720N</b>	M 20 x 1,5	6 - 12	10	24	26	20/100
<b>4725</b>	<b>4725N</b>	M 25 x 1,5	13 - 18	12	33	32	
<b>4732</b>	<b>4732N</b>	M 32 x 1,5	16 - 21	12	36	41	10/10
<b>4740</b>	<b>4740N</b>	M 40 x 1,5	20 - 26	15	46	49	5/5
<b>4750</b>	<b>4750N</b>	M 50 x 1,5	32 - 38	18	60	61	
<b>4763</b>	<b>4763N</b>	M 63 x 1,5	37 - 44	18	68	73	

**IP68**

**PASSO METRICO · IP68 · CON FILETTO LUNGO**  
 METRIC THREAD · IP68 · WITH LONG THREAD

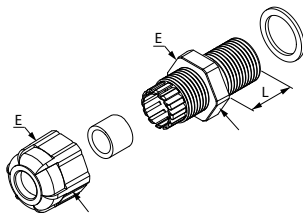

**MATERIALE:** poliammide (PA6.6), autoestinguente in accordo a: UL-94 - V2 e IEC 695-2-1 (850 °C)  
**TEMPERATURA D'ESERCIZIO:** da -20 °C a +90 °C  
**GUARNIZIONE INTERNA E RONDELLA:** NBR (gomma nitrilica), durezza 70 Shore A  
**NORME DI RIF.:** EN 62444:2013

**MATERIAL:** polyamide (PA6.6), self-extinguishing according to: UL-94 V2 and IEC 695-2-1 (850 °C)  
**OPERATING TEMPERATURE:** from -20 °C to +90 °C  
**INNER GASKET AND WASHER:** NBR (nitrile rubber), 70 Shore A hardness  
**ACCORDING TO STD.:** EN 62444:2013

Grigio RAL 7035 Grey RAL 7035	Nero RAL 9005 Black RAL 9005	Filetto Thread size	Diametro cavi Cable clamping range	Chiave Nut	
Articolo - Code	Articolo - Code	EN 60423	ø mm	L	E
<b>4912L</b>	<b>4912LN</b>	M 12 x 1,5	3 - 6,5	15	16
<b>4917L</b>	<b>4917LN</b>	M 16 x 1,5	4 - 8	15	19
<b>4920L</b>	<b>4920LN</b>	M 20 x 1,5	6 - 12	15	24
<b>4925L</b>	<b>4925LN</b>	M 25 x 1,5	13 - 18	15	33
<b>4932L</b>	<b>4932LN</b>	M 32 x 1,5	16 - 21	15	36
<b>4940L</b>	<b>4940LN</b>	M 40 x 1,5	20 - 26	18	46
<b>4950L</b>	<b>4950LN</b>	M 50 x 1,5	32 - 38	20	60
<b>4963L</b>	<b>4963LN</b>	M 63 x 1,5	37 - 44	20	68



**IP68**

**PASSO METRICO · IP68 · CON SPIRALE PROTEGGI-CAVO**  
 METRIC THREAD · IP68 · WITH SPIRAL CABLE PROTECTION

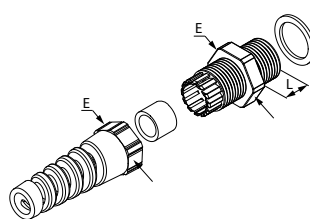

**MATERIALE:** poliammide (PA6.6), autoestinguente in accordo a: UL-94 - V2 e IEC 695-2-1 (850 °C)  
**TEMPERATURA D'ESERCIZIO:** da -20 °C a +90 °C  
**GUARNIZIONE INTERNA E RONDELLA:** NBR (gomma nitrilica), durezza 70 Shore A  
**NORME DI RIF.:** EN 62444:2013

**MATERIAL:** polyamide (PA6.6), self-extinguishing according to: UL-94 V2 and IEC 695-2-1 (850 °C)  
**OPERATING TEMPERATURE:** from -20 °C to +90 °C  
**INNER GASKET AND WASHER:** NBR (nitrile rubber), 70 Shore A hardness  
**ACCORDING TO STD.:** EN 62444:2013

Grigio RAL 7035 Grey RAL 7035	Nero RAL 9005 Black RAL 9005	Filetto Thread size	Diametro cavi Cable clamping range	Chiave Nut	
Articolo - Code	Articolo - Code	EN 60423	ø mm	L	E
<b>4912S</b>	<b>4912SN</b>	M 12 x 1,5	3 - 6,5	15	16
<b>4917S</b>	<b>4917SN</b>	M 16 x 1,5	4 - 8	15	19
<b>4920S</b>	<b>4920SN</b>	M 20 x 1,5	6 - 12	15	24
<b>4925S</b>	<b>4925SN</b>	M 25 x 1,5	13 - 18	15	33



**IP68**

## PASSO METRICO · ACCESSORI: DADI ESAGONALI CON FLANGIA

METRIC THREAD · ACCESSORIES: HEXAGONAL LOCKNUTS WITH FLANGE

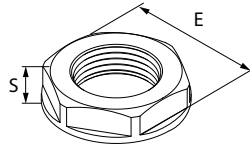

**MATERIALE:**  
 poliammide rinforzato  
 con fibra di vetro  
**TEMPERATURA D'ESERCIZIO:**  
 da -20 °C a +90 °C

**MATERIAL:**  
 polyamide reinforced with fiberglass  
**OPERATING TEMPERATURE:**  
 from -20 °C to +90 °C

Grigio RAL 7035 Grey RAL 7035	Nero RAL 9005 Black RAL 9005	Filetto Thread size				
Articolo - Code	Articolo - Code	EN 60423	E	S		
<b>4812</b>	<b>4812N</b>	M 12 x 1,5	17	5		
<b>4817</b>	<b>4817N</b>	M 16 x 1,5	22	5		
<b>4820</b>	<b>4820N</b>	M 20 x 1,5	26	6		100/500
<b>4825</b>	<b>4825N</b>	M 25 x 1,5	32	6		
<b>4832</b>	<b>4832N</b>	M 32 x 1,5	41	7		50/50
<b>4840</b>	<b>4840N</b>	M 40 x 1,5	50	7		25/25
<b>4850</b>	<b>4850N</b>	M 50 x 1,5	60	8		
<b>4863</b>	<b>4863N</b>	M 63 x 1,5	75	8		10/10

## PASSO METRICO · IP56 · ACCESSORI: TAPPI DI CHIUSURA

METRIC THREAD · IP56 · ACCESSORIES: STOP-ENDS

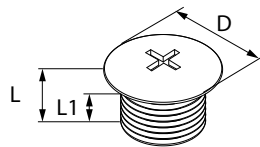

**MATERIALE:**  
 poliammide rinforzato con fibra di vetro  
**TEMPERATURA D'ESERCIZIO:**  
 da -40 °C a +100 °C

**MATERIAL:**  
 polyamide reinforced with fiberglass  
**OPERATING TEMPERATURE:**  
 from -40 °C to +100 °C

Grigio RAL 7035 Grey RAL 7035	Nero RAL 9005 Black RAL 9005	Filetto Thread size				
Articolo - Code	Articolo - Code	EN 60423	D	L	L1	
<b>4612</b>	<b>4612N</b>	M 12 x 1,5	15	8	6	
<b>4616</b>	<b>4616N</b>	M 16 x 1,5	20	9	6	
<b>4620</b>	<b>4620N</b>	M 20 x 1,5	24	9,5	6	100/100
<b>4625</b>	<b>4625N</b>	M 25 x 1,5	30	10	8	
<b>4632</b>	<b>4632N</b>	M 32 x 1,5	37	13,5	8	
<b>4640</b>	<b>4640N</b>	M 40 x 1,5	46	15	8	
<b>4650</b>	<b>4650N</b>	M 50 x 1,5	56	16	10	50/50
<b>4663</b>	<b>4663N</b>	M 63 x 1,5	70	16	12	25/25

# IP56

**PASSO METRICO · ACCESSORI: GUARNIZIONI PIATTE**  
 METRIC THREAD · ACCESSORIES: FLAT GASKETS

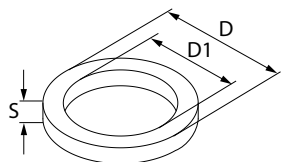

**MATERIALE:**  
 NBR (gomma nitrilica), durezza 60 Shore A  
 Resistente agli olii e ai grassi  
**TEMPERATURA DI ESERCIZIO:**  
 da -20 °C a +90 °C

**MATERIAL:**  
 NBR (nitrile rubber), 60 Shore A hardness  
 Resistant to oils and grease  
**OPERATING TEMPERATURE:**  
 from -20 °C to +90 °C

Articolo Code	Filetto Thread	D	D1	S	
4912G	M 12	16	11,8	2	100/500
4917G	M 16	20	15,8	2	
4920G	M 20	24	19,8	2	
4925G	M 25	29	24,8	2	
4932G	M 32	36	31,8	2	
4940G	M 40	46	39,8	2	100/100
4950G	M 50	56	49,8	2	
4963G	M 63	69	62,8	2	

**PASSO PG**  
 PG THREAD

**PASSO PG · IP68 · STANDARD**  
 PG THREAD · IP68 · STANDARD

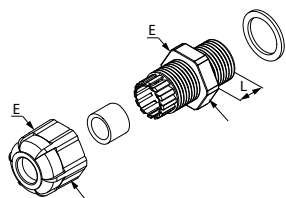

**MATERIALE:** poliammide (PA6.6),  
 autoestinguente in accordo a:  
 UL-94 - V2 e IEC 695-2-1 (850 °C)  
**TEMPERATURA D'ESERCIZIO:**  
 da -20 °C a +90 °C  
**GUARNIZIONE INTERNA E RONDELLA:**  
 NBR (gomma nitrilica), durezza 70 Shore A  
**NORME DI RIF.:** EN 62444:2013

**MATERIAL:** polyamide (PA6.6),  
 self-extinguishing according to:  
 UL-94 V2 and IEC 695-2-1 (850 °C)  
**OPERATING TEMPERATURE:**  
 from 0 °C to +90 °C  
**INNER GASKET AND WASHER:**  
 NBR (nitrile rubber), 70 Shore A hardness  
**ACCORDING TO STD.:** EN 62444:2013

Grigio RAL 7035 Grey RAL 7035	Grigio RAL 7001 Grey RAL 7001	Nero RAL 9005 Black RAL 9005	Filetto Thread size	Diametro cavi Cable clamping range	Chiave Nut		
Articolo - Code	Articolo - Code	Articolo - Code	DIN 40430	ø mm	L	E	
4007	4307	4007N	PG 7	3 - 6,5	9	16	50/500
4009	4309	4009N	PG 9	4 - 8	9	19	
4011	4311	4011N	PG 11	5 - 10	9	22	
4013	4313	4013N	PG 13,5	6 - 11	10	24	25/25
4016	4316	4016N	PG 16	10 - 13	10	27	20/200
4021	4321	4021N	PG 21	13 - 18	12	33	
4029	4329	4029N	PG 29	18 - 25	12	42	
4036	4336	4036N	PG 36	25 - 32	15	52	10/100
4042	4342	4042N	PG 42	32 - 38	18	60	
4048	4348	4048N	PG 48	37 - 44	18	68	



**IP68**



**PASSO PG · IP68 · CON DADO DI FISSAGGIO**

PG THREAD · IP68 · WITH LOCKNUT

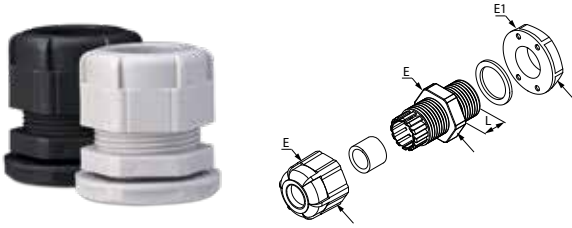

**MATERIALE:** poliammide (PA6,6), autoestinguente in accordo a: UL-94 - V2 e IEC 695-2-1 (850 °C)  
**TEMPERATURA D'ESERCIZIO:** da -20 °C a +90 °C  
**GUARNIZIONE INTERNA E RONDELLA:** NBR (gomma nitrilica), durezza 70 Shore A  
**NORME DI RIF.:** EN 62444:2013

**MATERIAL:** polyamide (PA6.6), self-extinguishing according to: UL-94 V2 and IEC 695-2-1 (850 °C)  
**OPERATING TEMPERATURE:** from -20 °C to +90 °C  
**INNER GASKET AND WASHER:** NBR (nitrile rubber), 70 Shore A hardness  
**ACCORDING TO STD.:** EN 62444:2013

Grigio RAL 7035 Grey RAL 7035	Nero RAL 9005 Black RAL 9005	Filetto Thread size	Diametro cavi Cable clamping range	Chiave Nut	Chiave Locknut	
Articolo - Code	Articolo - Code	DIN 40430	ø mm	L	E	E1
<b>4707</b>	<b>4707N</b>	PG 7	3 - 6,5	9	16	19
<b>4709</b>	<b>4709N</b>	PG 9	4 - 8	9	19	22
<b>4711</b>	<b>4711N</b>	PG 11	5 - 10	9	22	24
<b>4713</b>	<b>4713N</b>	PG 13,5	6 - 11	10	24	27
<b>4716</b>	<b>4716N</b>	PG 16	10 - 13	10	27	30
<b>4721</b>	<b>4721N</b>	PG 21	13 - 18	12	33	36
<b>4729</b>	<b>4729N</b>	PG 29	18 - 25	12	42	46
<b>4736</b>	<b>4736N</b>	PG 36	25 - 32	15	52	56
<b>4742</b>	<b>4742N</b>	PG 42	32 - 38	18	60	65
<b>4748</b>	<b>4748N</b>	PG 48	37 - 44	18	68	69

**IP68**
**PASSO PG · IP68 · CON FLANGIA**

PG THREAD · IP68 · WITH FLANGE

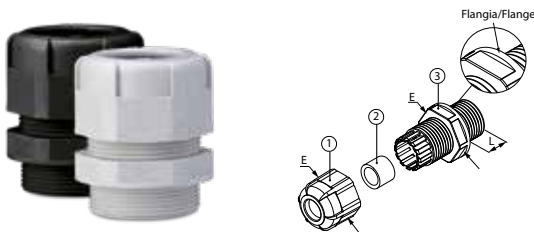

**MATERIALE:** poliammide (PA6,6), autoestinguente in accordo a: UL-94 - V2 e IEC 695-2-1 (850 °C)  
**TEMPERATURA D'ESERCIZIO:** da -20 °C a +90 °C  
**GUARNIZIONE INTERNA:** NBR (gomma nitrilica), durezza 60 Shore A  
**NORME DI RIF.:** EN 62444:2013

**MATERIAL:** polyamide (PA6.6), self-extinguishing according to: UL-94 V2 and IEC 695-2-1 (850 °C)  
**OPERATING TEMPERATURE:** from -20 °C to +90 °C  
**INNER GASKET:** NBR (nitrile rubber), 60 Shore A hardness  
**ACCORDING TO STD.:** EN 62444:2013

Grigio RAL 7035 Grey RAL 7035	Nero RAL 9005 Black RAL 9005	Filetto Thread size	Diametro cavi Cable clamping range	Chiave Nut	
Articolo - Code	Articolo - Code	DIN 40430	ø mm	L	E
<b>4907**</b>	<b>49071**</b>	PG 7	3 - 6,5	8	15
<b>4909**</b>	<b>49091**</b>	PG 9	4 - 8	8	19
<b>4911**</b>	<b>49111**</b>	PG 11	5 - 10	8	22
<b>4913*</b>	<b>49131*</b>	PG 13,5	6 - 12	10	24
<b>4916*</b>	<b>49161*</b>	PG 16	10 - 14	10	27
<b>4921*</b>	<b>49211*</b>	PG 21	13 - 18	11	33
<b>4929</b>	<b>49291</b>	PG 29	18 - 25	11	42
<b>4936*</b>	<b>49361*</b>	PG 36	22 - 32	13	53

Quando si installa il pressacavo su pannelli con foro passante, per mantenere le certificazioni UL e CSA, è necessario usare i dadi 48xx a pagina 195.  
 When installing the cable gland on panels with through hole, you need to use the 48xx nuts on page 195 to preserve UL and CSA certifications.

\* file n° E171361

\*\* file n° E171361

LR 44081-10

**IP68**

## PASSO PG · IP68 · CON FILETTO LUNGO

PG THREAD · IP68 · WITH LONG THREAD

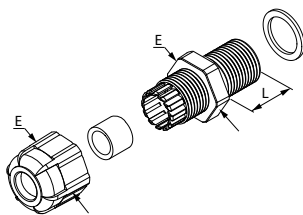

**MATERIALE:** poliammide (PA6.6),  
autoestinguente in accordo a:  
UL-94 - V2 e IEC 695-2-1 (850 °C)  
**TEMPERATURA D'ESERCIZIO:**  
da -20 °C a +90 °C  
**GUARNIZIONE INTERNA E RONDELLA:**  
NBR (gomma nitrilica), durezza 70 Shore A  
**NORME DI RIF.:** EN 62444:2013

**MATERIAL:** polyamide (PA6.6),  
self-extinguishing according to:  
UL-94 V2 and IEC 695-2-1 (850 °C)  
**OPERATING TEMPERATURE:**  
from -20 °C to +90 °C  
**INNER GASKET AND WASHER:**  
NBR (nitrile rubber), 70 Shore A hardness  
**ACCORDING TO STD.:** EN 62444:2013

Grigio RAL 7035 Grey RAL 7035	Nero RAL 9005 Black RAL 9005	Filetto Thread size	Diametro cavi Cable clamping range	Chiave Nut	
Articolo - Code	Articolo - Code	DIN 40430	ø mm	L	E
<b>4007L</b>	<b>4007LN</b>	PG 7	3 - 6,5	15	16
<b>4009L</b>	<b>4009LN</b>	PG 9	4 - 8	15	19
<b>4011L</b>	<b>4011LN</b>	PG 11	5 - 10	15	22
<b>4013L</b>	<b>4013LN</b>	PG 13,5	6 - 11	15	24
<b>4016L</b>	<b>4016LN</b>	PG 16	10 - 13	15	27
<b>4021L</b>	<b>4021LN</b>	PG 21	13 - 18	15	33
<b>4029L</b>	<b>4029LN</b>	PG 29	18 - 25	15	42
<b>4036L</b>	<b>4036LN</b>	PG 36	25 - 32	18	52
<b>4042L</b>	<b>4042LN</b>	PG 42	32 - 38	20	60
<b>4048L</b>	<b>4048LN</b>	PG 48	37 - 44	20	68

**IP68**

## PASSO PG · IP68 · CON SPIRALE PROTEGGI-CAVO

PG THREAD · IP68 · WITH SPIRAL CABLE PROTECTION

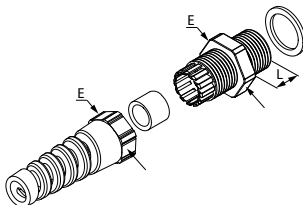

**MATERIALE:** poliammide (PA6.6),  
autoestinguente in accordo a:  
UL-94 - V2 e IEC 695-2-1 (850 °C)  
**TEMPERATURA D'ESERCIZIO:**  
da -20 °C a +90 °C  
**GUARNIZIONE INTERNA E RONDELLA:**  
NBR (gomma nitrilica), durezza 70 Shore A  
**NORME DI RIF.:** EN 62444:2013

**MATERIAL:** polyamide (PA6.6),  
self-extinguishing according to:  
UL-94 V2 and IEC 695-2-1 (850 °C)  
**OPERATING TEMPERATURE:**  
from -20 °C to +90 °C  
**INNER GASKET AND WASHER:**  
NBR (nitrile rubber), 70 Shore A hardness  
**ACCORDING TO STD.:** EN 62444:2013

Grigio RAL 7035 Grey RAL 7035	Nero RAL 9005 Black RAL 9005	Filetto Thread size	Diametro cavi Cable clamping range	Chiave Nut	
Articolo - Code	Articolo - Code	DIN 40430	ø mm	L	E
<b>4007S</b>	<b>4007SN</b>	PG 7	3 - 6,5	15	16
<b>4009S</b>	<b>4009SN</b>	PG 9	4 - 8	15	19
<b>4011S</b>	<b>4011SN</b>	PG 11	5 - 10	15	22
<b>4013S</b>	<b>4013SN</b>	PG 13,5	6 - 11	15	24
<b>4016S</b>	<b>4016SN</b>	PG 16	10 - 13	15	27
<b>4021S</b>	<b>4021SN</b>	PG 21	13 - 16	15	33

**IP68**

## PASSO PG · IP54 · RINFORZATO IN FIBRA DI VETRO

PG THREAD · IP54 · REINFORCED WITH FIBERGLASS

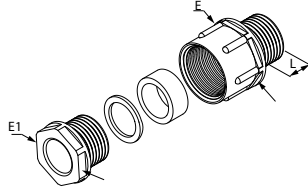

**MATERIALE:**  
 poliammide rinforzato con fibra di vetro  
**AUTOESTINGUENZA:** UL 94 - HB  
**TEMPERATURA D'ESERCIZIO:**  
 da -20 °C a +80 °C  
**NORME DI RIF.:** DIN 46320

**MATERIAL:**  
 polyamide reinforced with fiberglass  
**SELF-EXTINGUISHING:** UL 94 - HB  
**OPERATING TEMPERATURE:**  
 from -20 °C to +80 °C  
**ACCORDING TO STD.:** DIN 46320

Grigio RAL 7035 Grey RAL 7035	Filetto Thread size	Diametro cavi Cable clamping range	Chiave Nut	Chiave Locknut		
Articolo - Code	DIN 40430	ø mm	L	E	E1	
<b>3596</b>	PG 7	3,5 - 6	8	15	13	
<b>3597</b>	PG 9	4,5 - 7	8	19	16	
<b>3598</b>	PG 11	6 - 9	8	22	19	50/50
<b>3599</b>	PG 13,5	9 - 12	9	24	21	
<b>3600</b>	PG 16	11 - 14	10	27	23	
<b>3601</b>	PG 21	14 - 18	11	33	30	25/25
<b>3602</b>	PG 29	18 - 25	11	42	40	20/20
<b>3603</b>	PG 36	25 - 32	13	53	50	10/10
<b>3604</b>	PG 42	30 - 38	13	60	55	
<b>3605</b>	PG 48	38 - 44	15	65	60	5/5

**IP54**

## PASSO PG · ACCESSORI: DADI ESAGONALI

PG THREAD · ACCESSORIES: HEXAGONAL LOCKNUTS

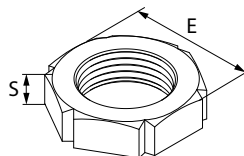

**MATERIALE:**  
 poliammide rinforzato con fibra di vetro  
**TEMPERATURA DI ESERCIZIO:**  
 da -20 °C a +90 °C

**MATERIAL:**  
 polyamide reinforced with fiberglass  
**OPERATING TEMPERATURE:**  
 from -20 °C to +90 °C

Grigio RAL 7035 Grey RAL 7035	Filetto Thread size			
Articolo - Code	DIN 40430	E	S	
<b>3696</b>	PG 7	19	5	
<b>3697</b>	PG 9	22	5	
<b>3698</b>	PG 11	24	4	100/100
<b>3699</b>	PG 13,5	27	6	
<b>3700</b>	PG 16	30	6	
<b>3701</b>	PG 21	36	7	
<b>3702</b>	PG 29	46	7	50/50
<b>3703</b>	PG 36	60	8	25/25
<b>3704</b>	PG 42	65	8	
<b>3705</b>	PG 48	70	8	10/10

**PASSO PG · ACCESSORI: DADI ESAGONALI CON FLANGIA**  
 PG THREAD · ACCESSORIES: HEXAGONAL LOCKNUTS WITH FLANGE

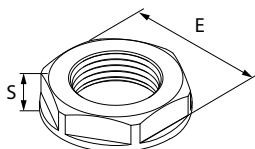

**MATERIALE:**  
 poliammide rinforzato con fibra di vetro  
**TEMPERATURA DI ESERCIZIO:**  
 da -20 °C a +90 °C

**MATERIAL:**  
 polyamide reinforced with fiberglass  
**OPERATING TEMPERATURE:**  
 from -20 °C to +90 °C

Grigio RAL 7035 Grey RAL 7035	Nero RAL 9005 Black RAL 9005	Filetto Thread size			
Articolo - Code	Articolo - Code	DIN 40430	E	S	
<b>4807**</b>	<b>4807N**</b>	PG 7	19	5	
<b>4809**</b>	<b>4809N**</b>	PG 9	22	5	
<b>4811**</b>	<b>4811N**</b>	PG 11	24	5	
<b>4813*</b>	<b>4813N*</b>	PG 13,5	27	6	100/500
<b>4816*</b>	<b>4816N*</b>	PG 16	30	6	
<b>4821*</b>	<b>4821N*</b>	PG 21	36	7	
<b>4829</b>	<b>4829N</b>	PG 29	46	7	50/50
<b>4836*</b>	<b>4836N*</b>	PG 36	60	8	25/25
<b>4842</b>	<b>4842N</b>	PG 42	65	8	
<b>4848</b>	<b>4848N</b>	PG 48	70	8	10/10

Utilizzare questi dadi per preservare le certificazioni UL e CSA dei pressacavi 49xx a pagina 192 installati su pannelli a foro passante.  
 Use these nuts to preserve UL and CSA certifications of the 49XX cable glands on page 192 when installed on through-hole panels.



\* file n° E171361



\*\* file n° E171361



LR 44081-10

**PASSO PG · IP56 · ACCESSORI: TAPPI DI CHIUSURA**  
 PG THREAD · IP56 · ACCESSORIES: STOP-ENDS

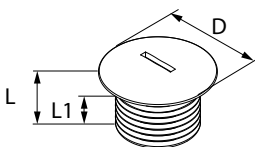

**MATERIALE:** polistirene  
**TEMPERATURA D'ESERCIZIO:**  
 da -25 °C a +60 °C  
**PER BREVI PERIODI:** +80 °C

**MATERIAL:** polystyrene  
**OPERATING TEMPERATURE:**  
 from -25 °C to +60 °C  
**FOR SHORT PERIODS:** +80 °C

Grigio RAL 7035 Grey RAL 7035	Nero RAL 9005 Black RAL 9005	Filetto Thread size			
Articolo - Code	Articolo - Code	DIN 40430	D	L	L1
<b>4596</b>	<b>4596N</b>	PG 7	15	8	6
<b>4597</b>	<b>4597N</b>	PG 9	19	9	6
<b>4598</b>	<b>4598N</b>	PG 11	22	9	6
<b>4599</b>	<b>4599N</b>	PG 13,5	25	9,5	6
<b>4600</b>	<b>4600N</b>	PG 16	27	9,5	6
<b>4601</b>	<b>4601N</b>	PG 21	33	11	8
<b>4602</b>	<b>4602N</b>	PG 29	44	12	8
<b>4603</b>	<b>4603N</b>	PG 36	55	15	10
<b>4604</b>	<b>4604N</b>	PG 42	62	16	10
<b>4605</b>	<b>4605N</b>	PG 48	69	16	12

**IP56**

## PASSO PG · ACCESSORI: GUARNIZIONI PIATTE

PG THREAD · ACCESSORIES: FLAT GASKETS

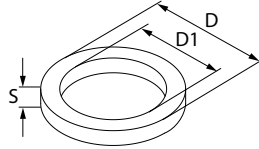

**MATERIALE:**  
 NBR (gomma nitrilica), durezza 60 Shore A  
 Resistente agli olii e ai grassi  
**TEMPERATURA DI ESERCIZIO:**  
 da -20 °C a +90 °C

**MATERIAL:**  
 NBR (nitrile rubber), 60 Shore A hardness  
 Resistant to oils and grease  
**OPERATING TEMPERATURE:**  
 from -20 °C to +90 °C

Articolo Code	Filetto Thread	D	D1	S	
<b>4907G</b>	PG 7	16,5	12,5	2	
<b>4909G</b>	PG 9	19	15,2	2	
<b>4911G</b>	PG 11	22,5	18,6	2	
<b>4913G</b>	PG 13,5	25	20,4	2	100/500
<b>4916G</b>	PG 16	27	22,5	2	
<b>4921G</b>	PG 21	33,5	28,3	3	
<b>4929G</b>	PG 29	43,5	37	3	
<b>4936G</b>	PG 36	55	47	3	
<b>4942G</b>	PG 42	63	54	3	100/100
<b>4948G</b>	PG 48	69	59,3	3	

## PASSO GAS · IP54 · STANDARD

GAS THREAD · IP54 · STANDARD

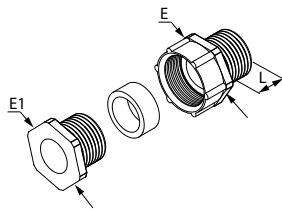

**MATERIALE:** poliammide (PA6.6)  
**AUTOESTINGUENZA:**  
 UL 94 V-2 IEC 695-2-1 a 850 °C  
**TEMPERATURA D'ESERCIZIO:**  
 da -20 °C a +90 °C

**MATERIAL:** polyamide (PA6.6)  
**SELF-EXTINGUISHING:**  
 UL 94 V-2 IEC 695-2-1 at 850 °C  
**OPERATING TEMPERATURE:**  
 from -20 °C to +90 °C

Grigio RAL 7035 Grey RAL 7035	Filetto Gas Gas thread	Diametro cavi Cable clamping range	Chiave Nut	Chiave Locknut	
Articolo - Code	ISO 228/1	ø mm	L	E	E1
<b>3451</b>	G 3/8"	7 - 10	7,5	21	19
<b>3452</b>	G 1/2"	11 - 13	9	25	23
<b>3453</b>	G 5/8"	13,5 - 15	10	27	25
<b>3454</b>	G 3/4"	16 - 18	10,5	30	29
<b>3455</b>	G 1"	19 - 22	12	38	36



**IP54**

## PASSO GAS · ACCESSORI: DADI ESAGONALI

GAS THREAD · ACCESSORIES: HEXAGONAL LOCKNUTS

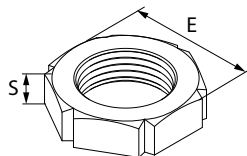

**MATERIALE:**  
poliammide rinforzato con fibra di vetro  
**TEMPERATURA DI ESERCIZIO:**  
da -20 °C a +90 °C

**MATERIAL:**  
polyamide reinforced with fiberglass  
**OPERATING TEMPERATURE:**  
from -20 °C to +90 °C

Grigio RAL 7035 Grey RAL 7035	Filetto Gas Gas thread			
Articolo - Code	ISO 228/1	E	S	
<b>3461</b>	G 3/8"	22	5,5	
<b>3462</b>	G 1/2"	27	5,5	
<b>3463</b>	G 5/8"	30	6	100/100
<b>3464</b>	G 3/4"	32	6,5	
<b>3465</b>	G 1"	39	7,5	50/50

**ACCESSORI: FERMACAVI**

ACCESSORIES: CABLE CLAMPS

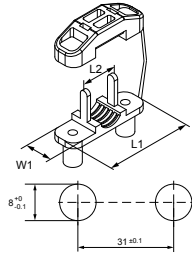

**MATERIALE:** poliammide (PA6,6)  
 nero UL 94 - V2  
**TEMPERATURA D'ESERCIZIO:** 125 °C  
 Completo di due viti per materiali plastici M3, 5x16 per il fissaggio del supporto fermacavo su lamiera con spessore da 0,6 a 1,5 mm. Adatto per il bloccaggio di cavi con sezioni da 3x0,75 a 3x2,5 mm<sup>2</sup> o con diametro esterno da 6 a 13 mm. Interasse tra i fori di fissaggio sulla lamiera: 31 - 0,1 mm. Diametro fori: 8 + 0 - 0,1.

**MATERIAL:** polyamide (PA6.6)  
 black UL 94 - V2  
**OPERATING TEMPERATURE:** 125 °C  
 Complete with two screws for M3 plastic materials, 5x16 for fastening the cable holder on metal sheets with thickness from 0.6 to 1.5 mm. Suitable for the clamping of cables with sections from 3x0.75 to 3x2.5 mm<sup>2</sup> or with external diameter from 6 to 13 mm. Distance between the fixing holes on metal sheet: 31 - 0.1 mm. Holes diameter: 8 + 0 - 0.1.

 Articolo  
 Code



	A	B	C	
<b>M932</b>	44,3	14,6	14,5	100/100



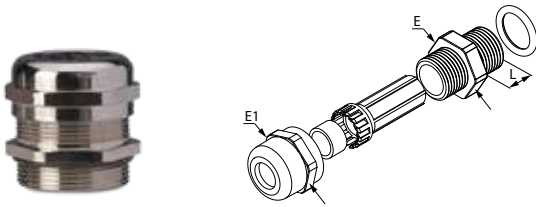

## PASSO METRICO METRIC THREAD

### PASSO METRICO · IP68 · STANDARD METRIC THREAD · IP68 · STANDARD



**MATERIALE:** ottone nichelato  
**TEMPERATURA D'ESERCIZIO:**  
 da -40 °C a +100 °C  
**GUARNIZIONE INTERNA E O-RING:**  
 NBR (gomma nitrilica), durezza 70 Shore A  
**GABBIA:** poliammide (PA6.6)

**MATERIAL:** nickel-plated brass  
**OPERATING TEMPERATURE:**  
 from -40 °C to +100 °C  
**INNER GASKET AND O-RING:**  
 NBR (nitrile rubber), 70 Shore A hardness  
**CAGE:** polyamide (PA6.6)

Articolo Code	Filetto Thread size	Diametro cavi Cable clamping range	Chiave Nut	Chiave Locknut	
	EN 60423	ø mm	L	E	E1
<b>2512</b>	M 12 x 1,5	3 - 6,5	6	14	14
<b>2517</b>	M 16 x 1,5	4 - 8	7	18	18
<b>2520</b>	M 20 x 1,5	6 - 12	9	22	22
<b>2525</b>	M 25 x 1,5	10 - 14	9	27	24
<b>2532</b>	M 32 x 1,5	15 - 22	10	34	34
<b>2540</b>	M 40 x 1,5	18 - 25	10	45	45
<b>2550</b>	M 50 x 1,5	32 - 38	10	58	58
<b>2563</b>	M 63 x 1,5	37 - 44	12	68	64

**IP68**

### PASSO METRICO · IP68 · CON FILETTO LUNGO METRIC THREAD · IP68 · WITH LONG THREAD

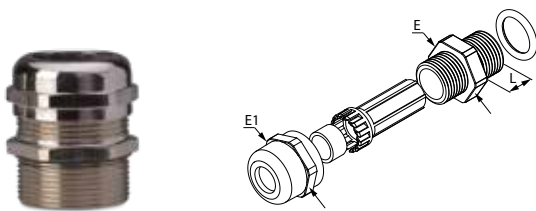

**MATERIALE:** ottone nichelato  
**TEMPERATURA D'ESERCIZIO:**  
 da -40 °C a +100 °C  
**GUARNIZIONE INTERNA E O-RING:**  
 NBR (gomma nitrilica), durezza 70 Shore A  
**GABBIA:** poliammide (PA6.6)

**MATERIAL:** nickel-plated brass  
**OPERATING TEMPERATURE:**  
 from -40 °C to +100 °C  
**INNER GASKET AND O-RING:**  
 NBR (nitrile rubber), 70 Shore A hardness  
**CAGE:** polyamide (PA6.6)

Articolo Code	Filetto Thread size	Diametro cavi Cable clamping range	Chiave Nut	Chiave Locknut	
	EN 60423	ø mm	L	E	E1
<b>2512L</b>	M 12 x 1,5	3 - 6,5	10	14	14
<b>2517L</b>	M 16 x 1,5	4 - 8	10	18	18
<b>2520L</b>	M 20 x 1,5	6 - 12	10	22	22
<b>2525L</b>	M 25 x 1,5	10 - 14	12	27	24
<b>2532L</b>	M 32 x 1,5	15 - 22	14	34	34
<b>2540L</b>	M 40 x 1,5	18 - 25	15	45	45
<b>2550L</b>	M 50 x 1,5	32 - 38	15	58	58
<b>2563L</b>	M 63 x 1,5	37 - 44	15	68	64

**IP68**

**PASSO METRICO · IP54 · STANDARD**  
 METRIC THREAD · IP54 · STANDARD

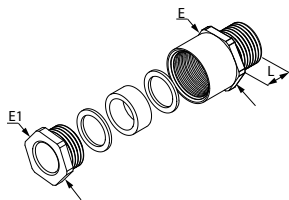

**MATERIALE:** ottone nichelato  
**TEMPERATURA D'ESERCIZIO:**  
 da -20 °C a +70 °C  
**GUARNIZIONE INTERNA:**  
 NBR (gomma nitrilica), durezza 70 Shore A

**MATERIAL:** nickel-plated brass  
**OPERATING TEMPERATURE:**  
 from -20 °C to +70 °C  
**INNER GASKET:**  
 NBR (nitrile rubber), 70 Shore A hardness

Articolo Code	Filetto Thread size	Diametro cavi Cable clamping range	Chiave Nut	Chiave Nut	Chiave Nut	
	EN 60423	ø mm	L	E	E1	
<b>2812</b>	M 12 x 1,5	4 - 6	5	14	13	100/100
<b>2816</b>	M 16 x 1,5	8 - 10	6	17	15	
<b>2820</b>	M 20 x 1,5	10 - 12	7	22	20	
<b>2825</b>	M 25 x 1,5	17 - 19	8,5	30	28	50/50
<b>2832</b>	M 32 x 1,5	19 - 22	9	35	33	
<b>2840</b>	M 40 x 1,5	26 - 30	10,2	45	42	25/25
<b>2850</b>	M 50 x 1,5	39 - 41	10	57	54	10/10
<b>2863</b>	M 63 x 1,5	43 - 45	12	64	60	



**IP54**

**PASSO METRICO · ACCESSORI: DADI ESAGONALI**  
 METRIC THREAD · ACCESSORIES: HEXAGONAL LOCKNUTS

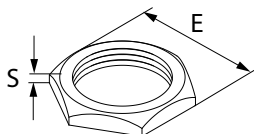

**MATERIALE:** ottone nichelato  
**TEMPERATURA D'ESERCIZIO:**  
 da -40 °C a +100 °C

**MATERIAL:** nickel-plated brass  
**OPERATING TEMPERATURE:**  
 from -40 °C to +100 °C

Articolo Code	Filetto Thread size	E	S	
	EN 60423	E	S	
<b>2712</b>	M 12 x 1,5	15	2,8	100/100
<b>2716</b>	M 16 x 1,5	19	3	
<b>2720</b>	M 20 x 1,5	24	3,2	
<b>2725</b>	M 25 x 1,5	30	3,5	
<b>2732</b>	M 32 x 1,5	37	4	50/50
<b>2740</b>	M 40 x 1,5	46	5	25/25
<b>2750</b>	M 50 x 1,5	60	5,5	
<b>2763</b>	M 63 x 1,5	70	5,7	10/10

## PASSO METRICO · IP68 · ACCESSORI: TAPPI DI CHIUSURA

METRIC THREAD · IP68 · ACCESSORIES: STOP-ENDS

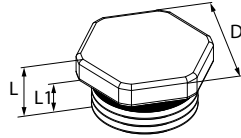

**MATERIALE:** ottone nichelato  
**TEMPERATURA D'ESERCIZIO:**  
 da -40 °C a +100 °C  
**GUARNIZIONE INTERNA E RONDELLA:**  
 NBR (gomma nitrilica), durezza 70 Shore A

**MATERIAL:** nickel-plated brass  
**OPERATING TEMPERATURE:**  
 from -40 °C to +100 °C  
**INNER GASKET AND WASHER:**  
 NBR (nitrile rubber), 70 Shore A hardness

Articolo Code	Filetto Thread size	Chiave Nut	Chiave Nut		
	EN 60423	E	L	L1	
<b>2612</b>	M 12 x 1,5	14	8	5	100/3500
<b>2616</b>	M 16 x 1,5	18	9	6	100/2500
<b>2620</b>	M 20 x 1,5	22	10	7	100/1200
<b>2625</b>	M 25 x 1,5	28	10	7	100/800
<b>2632</b>	M 32 x 1,5	36	12	8	100/400
<b>2640</b>	M 40 x 1,5	45	14	9	100/300
<b>2650</b>	M 50 x 1,5	55	15	9	50/150
<b>2663</b>	M 63 x 1,5	70	16	10	50/100

### IP68

## PASSO PG PG THREAD

## PASSO PG · IP68 · STANDARD

PG THREAD · IP68 · STANDARD

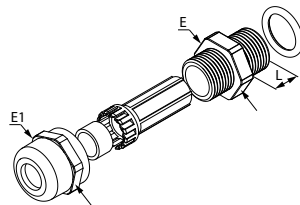

**MATERIALE:** ottone nichelato  
**TEMPERATURA D'ESERCIZIO:**  
 da -40 °C a +100 °C  
**GUARNIZIONE INTERNA E O-RING:**  
 NBR (gomma nitrilica), durezza 70 Shore A  
**GABBIA:** poliammide (PA6.6)

**MATERIAL:** nickel-plated brass  
**OPERATING TEMPERATURE:**  
 from -40 °C to +100 °C  
**INNER GASKET AND O-RING:**  
 NBR (nitrile rubber), 70 Shore A hardness  
**CAGE:** polyamide (PA6.6)

Articolo Code	Filetto Thread size	Diametro cavi Cable clamping range	Chiave Nut	Chiave Locknut	
	DIN 40430	ø mm	L	E	E1
<b>2507</b>	PG 7	3 - 6,5	6	14	14
<b>2509</b>	PG 9	4 - 8	7	18	18
<b>2511</b>	PG 11	5 - 10	7	20	20
<b>2513</b>	PG 13,5	6 - 12	8	22	22
<b>2516</b>	PG 16	10 - 14	8	24	24
<b>2521</b>	PG 21	13 - 18	9	30	30
<b>2529</b>	PG 29	18 - 25	10	40	40
<b>2536</b>	PG 36	25 - 32	10	50	50
<b>2542</b>	PG 42	32 - 38	12	58	58
<b>2548</b>	PG 48	37 - 44	12	64	64

### IP68

**PASSO PG · IP68 · CON FILETTO LUNGO**

PG THREAD · IP68 · WITH LONG THREAD

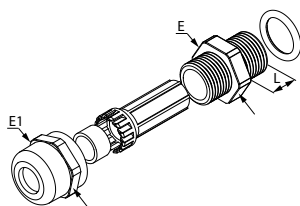

**MATERIALE:** ottone nichelato  
**TEMPERATURA D'ESERCIZIO:**  
 da -40 °C a +100 °C  
**GUARNIZIONE INTERNA E O-RING:**  
 NBR (gomma nitrilica), durezza 70 Shore A  
**GABBIA:** poliammide (PA6.6)

**MATERIAL:** nickel-plated brass  
**OPERATING TEMPERATURE:**  
 from -40 °C to +100 °C  
**INNER GASKET AND O-RING:**  
 NBR (nitrile rubber), 70 Shore A hardness  
**CAGE:** polyamide (PA6.6)

Articolo Code	Filetto Thread size	Diametro cavi Cable clamping range	Chiave Nut	Chiave Locknut	
	DIN 40430	ø mm	L	E	E1
<b>2507L</b>	PG 7	3 - 6,5	10	14	14
<b>2509L</b>	PG 9	4 - 8	10	18	18
<b>2511L</b>	PG 11	5 - 10	10	20	20
<b>2513L</b>	PG 13,5	6 - 12	10	22	22
<b>2516L</b>	PG 16	10 - 14	10	24	24
<b>2521L</b>	PG 21	13 - 18	12	30	30
<b>2529L</b>	PG 29	18 - 25	12	40	40
<b>2536L</b>	PG 36	25 - 32	15	50	50
<b>2542L</b>	PG 42	32 - 38	15	58	58
<b>2548L</b>	PG 48	37 - 44	15	64	64



**IP68**

**PASSO PG · IP54 · STANDARD**

PG THREAD · IP54 · STANDARD

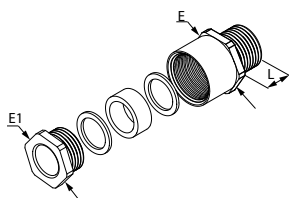

**MATERIALE:** ottone nichelato  
**TEMPERATURA D'ESERCIZIO:**  
 da -20 °C a +70 °C  
**GUARNIZIONE INTERNA:**  
 NBR (gomma nitrilica), durezza 70 Shore A

**MATERIAL:** nickel-plated brass  
**OPERATING TEMPERATURE:**  
 from -20 °C to +70 °C  
**INNER GASKET:**  
 NBR (nitrile rubber), 70 Shore A hardness

Articolo Code	Filetto Thread size	Diametro cavi Cable clamping range	Chiave Nut	Chiave Nut	
	DIN 40430	ø mm	L	E	E1
<b>2596</b>	PG 7	4 - 6	5	14	13
<b>2597</b>	PG 9	8 - 10	6	17	15
<b>2598</b>	PG 11	8 - 10	6	20	18
<b>2599</b>	PG 13,5	10 - 12	6,5	22	20
<b>2600</b>	PG 16	12 - 14	6,5	24	22
<b>2601</b>	PG 21	17 - 19	7	30	28
<b>2602</b>	PG 29	26 - 28	8	40	37
<b>2603</b>	PG 36	33 - 35	9	50	47
<b>2604</b>	PG 42	39 - 41	10	57	54
<b>2605</b>	PG 48	43 - 45	10	64	60



**IP54**

**PASSO PG · ACCESSORI: DADI ESAGONALI**

PG THREAD · ACCESSORIES: HEXAGONAL LOCKNUTS

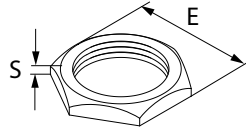

**MATERIALE:** ottone nichelato  
**TEMPERATURA D'ESERCIZIO:**  
 da -40 °C a +100 °C

**MATERIAL:** nickel-plated brass  
**OPERATING TEMPERATURE:**  
 from -40 °C to +100 °C

Articolo Code	Filetto Thread size			
	DIN 40430	E	S	
<b>2696</b>	PG 7	15	2,8	
<b>2697</b>	PG 9	18	3	
<b>2698</b>	PG 11	21	3	
<b>2699</b>	PG 13,5	23	3	100/100
<b>2700</b>	PG 16	26	3,25	
<b>2701</b>	PG 21	32	3,5	
<b>2702</b>	PG 29	42	4	
<b>2703</b>	PG 36	51	5	50/50
<b>2704</b>	PG 42	60	5	10/10
<b>2705</b>	PG 48	65	5,5	

**PASSO PG · IP68 · ACCESSORI: TAPPI DI CHIUSURA**

PG THREAD · IP68 · ACCESSORIES: STOP-ENDS

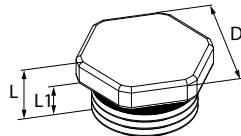

**MATERIALE:** ottone nichelato  
**TEMPERATURA D'ESERCIZIO:**  
 da -40 °C a +100 °C  
**GUARNIZIONE INTERNA E RONDELLA:**  
 NBR (gomma nitrilica), durezza 70 Shore A

**MATERIAL:** nickel-plated brass  
**OPERATING TEMPERATURE:**  
 from -40 °C to +100 °C  
**INNER GASKET AND WASHER:**  
 NBR (nitrile rubber), 70 Shore A hardness

Articolo Code	Filetto Thread size	Chiave Nut	Chiave Locknut		
	DIN 40430	E	L	L1	
<b>2796</b>	PG7	14	8	5	100/3500
<b>2797</b>	PG9	17	9	6	100/2500
<b>2798</b>	PG11	20	9	6	100/2000
<b>2799</b>	PG13.5	22	10	7	100/1200
<b>2800</b>	PG16	24	10	7	100/1000
<b>2801</b>	PG21	30	11	7	100/500
<b>2802</b>	PG29	40	12	8	100/300
<b>2803</b>	PG36	50	15	9	50/150
<b>2804</b>	PG42	60	16	10	50/100
<b>2805</b>	PG48	65	16	10	25/100

**IP68**

**PASSO GAS**  
GAS THREAD

**PASSO GAS · IP54 · STANDARD**  
GAS THREAD · IP54 · STANDARD

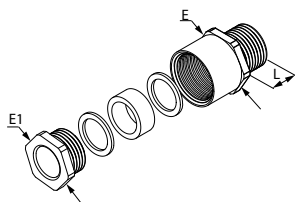

**MATERIALE:** ottone nichelato  
**TEMPERATURA D'ESERCIZIO:**  
da -20 °C a +70 °C  
**GUARNIZIONE INTERNA:**  
NBR (gomma nitrilica), durezza 70 Shore A

**MATERIAL:** nickel-plated brass  
**OPERATING TEMPERATURE:**  
from -20 °C to +70 °C  
**INNER GASKET:**  
NBR (nitrile rubber), 70 Shore A hardness

Articolo Code	Filetto Gas Gas thread	Diametro cavi Cable clamping range	Chiave Nut	Chiave Nut	
	ISO 228/1	ø mm	L	E	E1
<b>2450</b>	G 1/4"	4 - 6	5	14	13
<b>2451</b>	G 3/8"	8 - 10	6	17	15
<b>2452</b>	G 1/2"	10 - 12	7	22	20
<b>2453</b>	G 5/8"	12 - 14	7,5	24	22
<b>2454</b>	G 3/4"	17 - 19	8,5	30	28
<b>2455</b>	G 1"	19 - 22	9	35	33
<b>2456</b>	G 1" 1/8	26 - 28	10,5	40	37
<b>2457</b>	G 1" 1/4	26 - 30	10,2	45	42
<b>2458</b>	G 1" 1/2	33 - 35	12	50	47
<b>2459</b>	G 2"	43 - 45	12	64	60
<b>24592</b>	G 2" 1/2	55 - 57	12	80	80
<b>24593</b>	G 3"	67 - 69	20	95	95



**IP54**

**PASSO GAS · ACCESSORI: DADI ESAGONALI**  
GAS THREAD · ACCESSORIES: HEXAGONAL LOCKNUTS

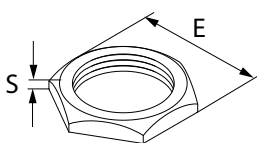

**MATERIALE:** ottone nichelato  
**TEMPERATURA D'ESERCIZIO:**  
da -20 °C a +70 °C

**MATERIAL:** nickel-plated brass  
**OPERATING TEMPERATURE:**  
from -20 °C to +70 °C

Articolo Code	Filetto Gas Gas thread	E	S	
	ISO 228/1	E	S	
<b>2460</b>	G 1/4"	15	2,8	
<b>2461</b>	G 3/8"	19	3,2	
<b>2462</b>	G 1/2"	24	3,75	100/100
<b>2463</b>	G 5/8"	26	3,75	
<b>2464</b>	G 3/4"	30	4	
<b>2465</b>	G 1"	37	4,5	
<b>2466</b>	G 1" 1/8	42	5	50/50
<b>2467</b>	G 1" 1/4	46	5	25/25
<b>2468</b>	G 1" 1/2	54	5,5	
<b>2469</b>	G 2"	65	5,7	20/20
<b>24692</b>	G 2" 1/2	80	7	5/5
<b>24693</b>	G 3"	95	8	10/10

## TAPPI DI CHIUSURA IP68

### IP68 STOP-ENDS

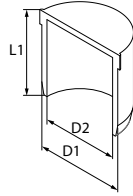

**MATERIALE:** poliammide  
**TEMPERATURA D'ESERCIZIO:**  
 da -40°C a +100°C  
**COLORE:** rosso  
**COPPIA DI SERRAGGIO:**  $\geq 1$  Nm  
**CAMPO DI APPLICAZIONE:**  
 adatto per chiudere il foro di passaggio  
 cavo dei pressa cavi IP68 in nylon e ottone  
**MONTAGGIO:**  
 Inserire il tappo con le alette di fine corsa in  
 battuta sulla guarnizione del pressa  
 cavo e serrare

**MATERIAL:** polyamide  
**OPERATING TEMPERATURE:**  
 from -40 °C to +100 °C  
**COLOR:** red  
**TIGHTENING TORQUE:**  $\geq 1$  Nm  
**APPLICATIONS:**  
 Suitable to close IP68 nylon and brass  
 cable gland holes  
**ASSEMBLY:**  
 Insert the plug with the end-stop wings  
 on the cable gland gasket and tighten

Articolo Code	D1	D2	L1	Metrico - Metric	PG	
<b>4206</b>	6	2.8	16	M12	PG7	50
				M16	PG9	
				M20	PG11	
					PG13.5	
<b>4213</b>	13	8.5	22	M25	PG16	50
					PG21	
<b>4220</b>	20	14.5	22	M32	PG29	25
				M40		
<b>4228</b>	28	22	30		PG36	25
<b>4238</b>	38	32	35	M50	PG42	10
				M63	PG48	

# IP68