

Timing Control Made Easy

7954 and 7957 Multi-function time relays

Versatile and easy to program

Programmable DIN Rail Time Relay





UL, cUL and CE, rated 

 Digital accuracy, easy to read display

MULTIPLE
timing ranges

up to **18**
selectable
timing functions

 Screw terminals for up to 14AWG wire

 Snap in DIN rail mounting

 Form C SPDT 8 AMP relay

 Output status indicator

 Only 17mm wide

Trumeter's new range of digital time relays offer 8 or 18 operating modes, easily configured on the 3 digit LCD display: a wide range of 0.1s - 999Hr to suit all applications; a clear indication of the relay status via the front panel LED; can accept a wide range of operating voltages for most installations. The keylock feature means settings cannot be tampered with, for 100% reliable operation.

Programming is retained during power shut down, the current timing is lost and will reset when power is back on.

Key Features

Features

- Compact 17.5mm wide DIN rail mountable
- 3 digit LCD for easy programming and run time indication
- Tamper proof with key lock feature
- Wide timing range: 0.1s - 999Hr
- Multi-function: 8 (7954) or 18 (7957) selectable operating modes
- Universal Voltage: 24 - 240VAC/VDC
- Option to select up/down timing
- CE, UL & cUL approved
- 8 AMP Form C (SPDT) Relay outputs

Programmable:

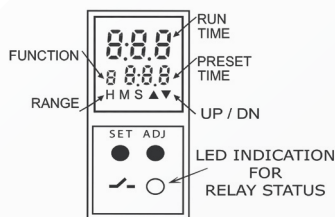

- Preset Time: The Timer Duration selected by the user
- Run Time: In Down counting ▼ mode it indicates the time remaining, while in Up counting ▲ mode indicates the elapsed time.
- Default Mode: Down counting ▼
- Up/Down ▼▲ blinks during the Timer Duration (T)

Specifications:

- Input voltage range
- Relay Capability
- Temp range
- Time ranges

Part Numbers

7954 8 Functions
7957 18 Functions

Operating modes

7957

- ON Delay
- Repeat Cycle OFF/ON
- Repeat Cycle ON/OFF
- Impulse on Power Up
- Accumulative Delay on Signal
- Accumulative Delay on Inverted Signal
- Accumulative Impulse on Signal
- Signal ON Delay
- Inverted Signal ON Delay
- Signal OFF Delay
- Impulse ON/OFF
- Signal OFF/ON
- Leading Edge Impulse 1
- Leading Edge Impulse 2
- Trailing Edge Impulse 1
- Trailing Edge Impulse 2
- Delayed Impulse
- Inverted Signal ON Delay (Type 2)

7954

- ON Delay
- Repeat Cycle OFF/ON
- Repeat Cycle ON/OFF
- Signal ON/OFF
- Signal OFF Delay
- Interval
- Signal OFF/ON
- One Shot Output

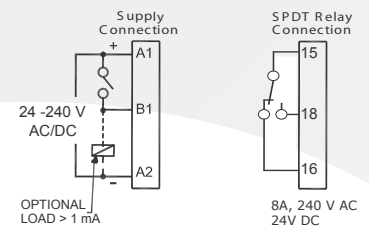

Easy To Program & Install

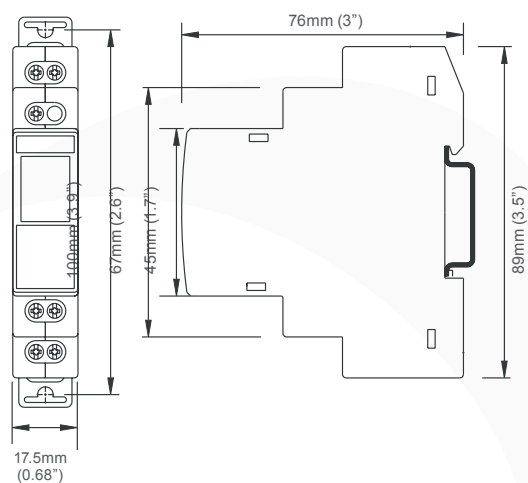

Full specifications available online www.trumeter.com