

The device can be operated intelligently via working with the SONOFF 433MHz RF Bridge to communicate with other devices.

- ⓘ The device can work with other gateways supporting 433MHz wireless protocol. Detailed information is in accordance with the final product.

Operation instruction

1. Download APP

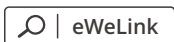

Android™ & iOS

2. Pull out the battery insulation sheet

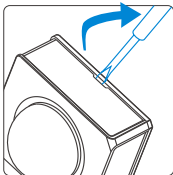

>

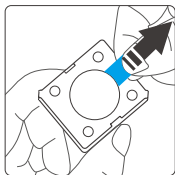

- ⓘ The device has the version with battery and without battery(Battery model: CR2450).

3. Add sub-devices

- ⓘ Connect the Bridge before adding the sub-device.

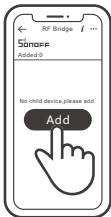

>

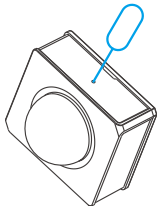

Launch eWeLink APP, select the Bridge to be paired, tap "Add" and select "Alarm", and you will hear a "Beep" that indicates the Bridge enters the pairing mode, then short press the pairing button on the device (or make the device detect the movement) that the pairing is successful when the red LED keeps on for 1s and the Bridge makes a "Beep-Beep" sound.

⚠ If the addition failed, move the sub-device closer to the Bridge and try again.

Installation methods

Method 1:

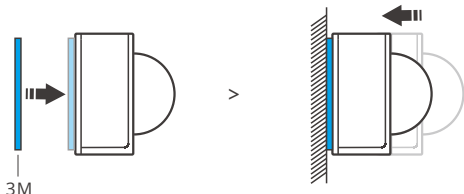

Method 2:

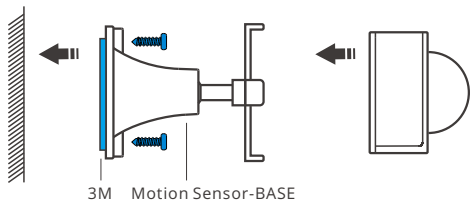

- ⚠ The motion sensor-base is not included, please purchase it separately.
- ⚠ Do not install on the metal surface, otherwise it will affect the wireless communication distance.
- ⚠ The device weight is less than 1 kg. The installation height of less than 2 m is recommended.

Specifications

| | |
|---------------------|---------------------------------------|
| Model | PIR3-RF |
| RF | 433.92MHz |
| Power supply | 3V button cell(Battery model: CR2450) |
| Detection Distance | ≤8m (Indoor space) |
| Detection angle | 100° |
| Working temperature | -10°C~40°C |
| Working humidity | 10-90%RH (non-condensing) |
| Material | PC |
| Dimension | 40x35x28mm |

Product Introduction

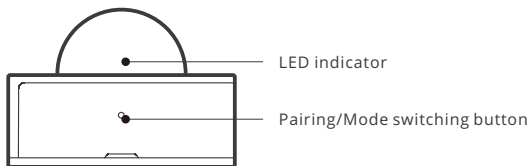

LED indicator status instruction

| LED indicator status | Status instruction |
|------------------------------|-----------------------------|
| Red LED is stays on for 1s | A movement is detected |
| Red LED is stays on for 5s | Switched to the "home" mode |
| Red LED flashes twice | Low-battery notification |
| Green LED is stays on for 5s | Switched to the "away" mode |

Features

PIR3-RF is a 433MHz low-energy motion sensor that can detect the movement of objects in real time. Connect it with the Bridge and you can create a smart scene to trigger other devices.



Low-energy



Movement detection



Alarm push
notification



Share control
(available for
SONOFF 433MHz
RF Bridge)



Smart scene

Application Mode

The device has "home" and "away" mode. The "away" mode is set by the factory default.

In the "home" mode, long press the mode switching button for 5s until the LED indicator flashes red and holds 5s, this indicates the device enters the "home" mode.

In the "home" mode, long press the mode switching button for 5s until the LED indicator flashes green and holds 5s, this indicates the device enters the "away" mode.

"Away" mode: Trigger a message and push to app once every 5s.

"Home" mode: trigger and push a message once when no any movement is detected for 60s.