



# Product Datasheet

Products Family: Outdoor Lighting Fixture

Products Name: LED Floodlight

Model No.: ESD floodlight Series

Product Code: BT61-23002 / BT61-23032

Department: R&D Center

**Purpose: Definite technical standard of LED light,direct LED examination**

**Basic specifications of product:**

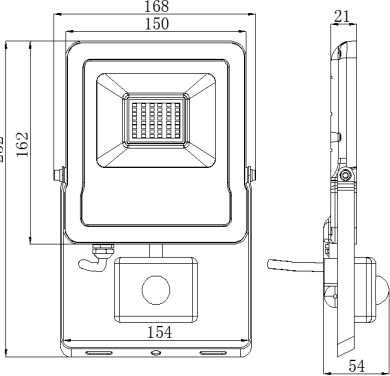
A、Appearance as right image:	
B、Light boundary dimension:168*209*27MM	
C、Lamp net weight: 0.5KG±30g	
D、Lamp color: Black/ Grey	
E、Material: glass;lamp body - Alu.ADC12;reflector - Aluminum 1060;	
F、LED Chip: 42pcs 2835 leds	
G、Power wire: conductor≥0.5mm <sup>2</sup> ; wire length: ≥0.15m(Exposed); tail end: copper-clad	
H、Power driving model: High-voltage linear driver;	
I、IP grade: IP44;electrical shock protection grade:I Class;	
J、Environment temperature: working -20°C~+45°C; storage -30°C~+60°C;	
K、Environment humidity: working- 10%~75%; storage- 10%~90%	
L、Lamp head: N/A	
M、Others: not dimmable, non-dimmable lamps	

**Electric parameter:**

Test condition:light for 15 mins under nominal voltage input and 25°C±1°working environment

Item name	Unit	Minimum	Typical value	Maximum	Remarks
Input Voltage	V	AC220	AC230	AC240	
Input Current	A	0,135	0,140	0,150	
Lamp power	W	30W±15%			
Power factor	PF	≥0.9			
Light power	W	30W±15%			
Frequency	Hz	47	50	63	
Output	DC: 252V;105mA±5%				
Power conversion efficiency	%	>85			

## Optical parameter requirement:

Test condition:light for 15 mins under 220V AC input and 25°C±1°working environment

Item name	Unit	Minimum value	Typical value	Maximum value	Remarks
Color temperature	K	/	/	/	
		/	/	/	
		5800	6150	6500	Cool White
Color rendering index(CR)	Ra	/			
		/			
		≥80			Cool White
Luminous Flux	lm	/			
		/			
		2400±%10			Cool White
Lighting effect	lm/W	/			
		/			
		80±%10			Cool White
Beam angle	°	100	110	120	
Chromaticity	SDCM	<10			

## Reliability requirements:

Item name	Standard specification
Lumen maintenance	Lumen maintenance is not lower than 92% after lighting for 3000h,and not lower than 88% after lighting for 6000H; and not lower than 70% after lighting for 70% of lifespan
Working life	Under nominal voltage input, working life is forced not lower than 25000h in 25°C±1°C
Guarantee period	3 years
IP grade	Must meet the test requirements of IEC or GB to the IP rating

## Optical and electrical test parameter:

### Spectrum Test Report

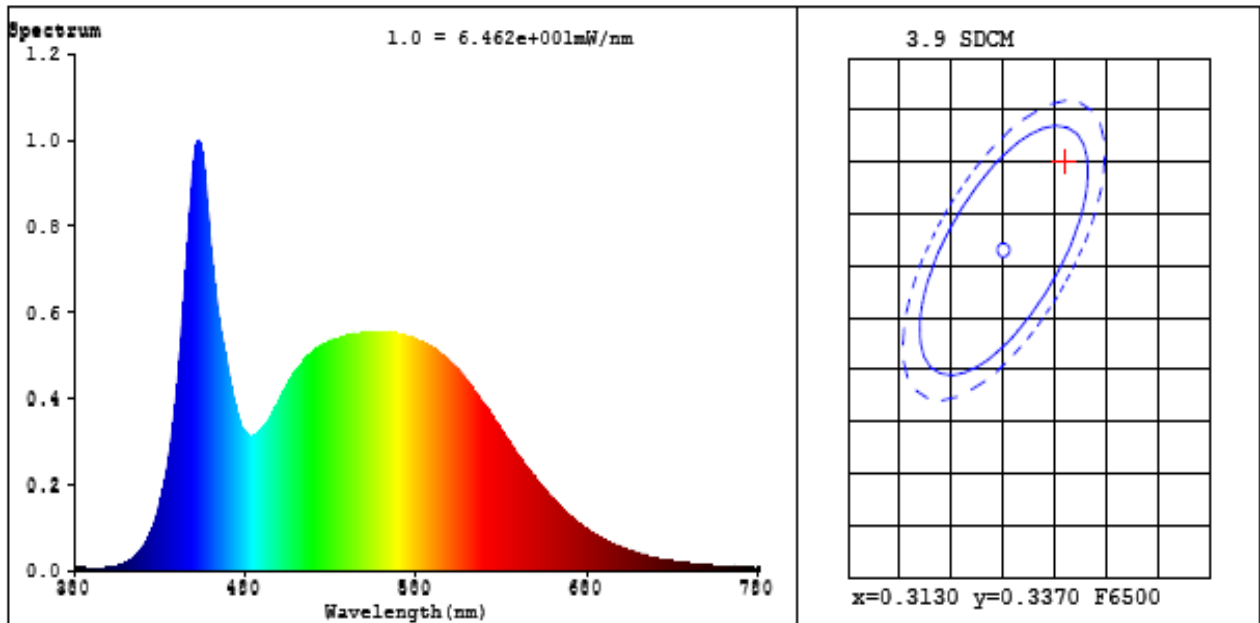

### Colorimetric Quantities

Chromaticity Coordinate:  $x=0.3180$   $y=0.3440$   $u'=0.1960$   $v'=0.4769$

CCT=6151K(Duv=0.0081) Dominant WL:Ld =500.9nm Purity=4.7%

Peak WL:Lp=453.0nm FWHM=26.6nm

Render Index:Ra=82.3

R1 =79 R2 =88 R3 =93 R4 =80 R5 =80 R6 =84 R7 =88

R8 =66 R9 =0 R10=71 R11=79 R12=59 R13=82 R14=97 R15=73

### Photometric & Radiometric Quantities

Flux = 2329 lm Eff. : 80.64 lm/W Fe = 7.356 W

Fmol(umol/s):33.241 Fluo. and blue light ratio:2.701 Fluorescent eff.:175.7

### Electrical parameters

V = 230.6 V I = 0.1325 A P = 28.88 W PF = 0.9451

Status: Integral T = 56 ms Ip = 48715 (74%)

Test Mode: Fast Test; Delicacy = High; Tecool: ON

## Surface of light intensity distribution:

### LUMINAIRE PHOTOMETRIC TEST REPORT

DATA OF LAMP		PHOTOMETRIC DATA				Eff: 82.25 lm/W
MODEL		I <sub>max</sub> (cd)	882.0	S/MH (C0/180)	1.33	
NOMINAL POWER (W)	28.3	LOR (%)	100.0	S/MH (C90/270)	1.30	
RATED VOLTAGE (V)	230	TOTAL FLUX (lm)	2327.7	η UP, DN (C0-180)	0.0, 52.0	
NOMINAL FLUX (lm)	2327.75	CIE CLASS	DIRECT	η UP, DN (C180-360)	0.0, 48.0	
LAMPS INSIDE	1	η up (%)	0.0	CIBSE SHR NOM	1.25	
TEST VOLTAGE (V)	0.0	η down (%)	100.0	CIBSE SHR MAX	1.35	

LUMINOUS INTENSITY DISTRIBUTION DIAGRAM

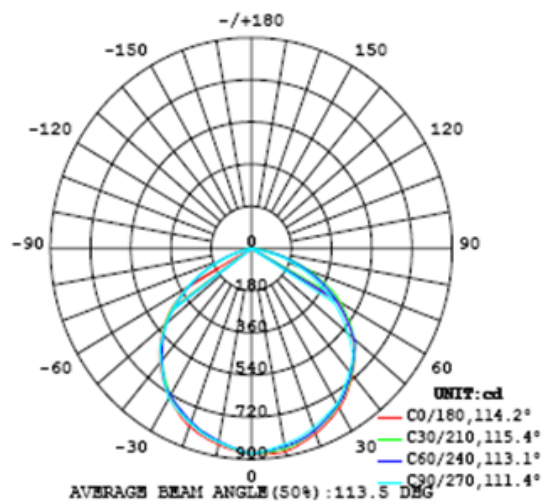

C0 PLANE ISOLUX DIAGRAM (UNIT: lx)

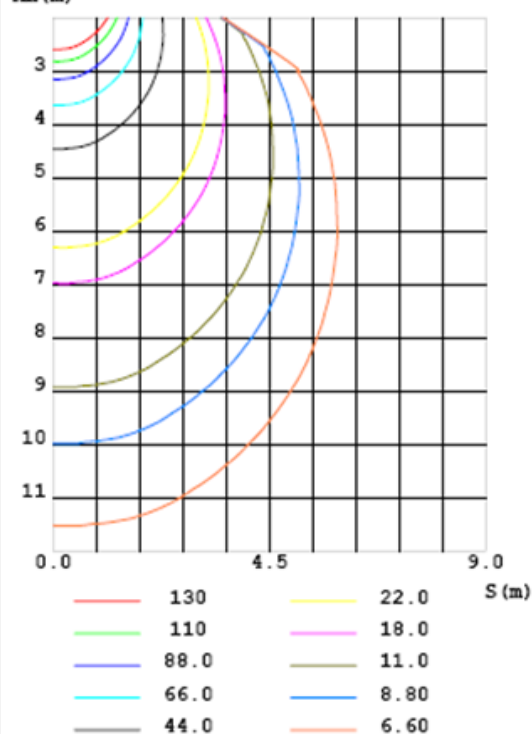

C Range: 0 - 360DEG  
C Interval: 5.0DEG  
Test Speed: HIGH  
Temperature: 25.3DEG  
Operators:  
Test Date: 2017-07-11

γ Range: 0 - 90DEG  
γ Interval: 0.5DEG  
Test System: EVERFINE GO-2000B\_V1 SYSTEM V2.0.266  
Humidity: 65.0%  
Test Distance: 10.110m [K=1.0000]  
Remarks:

Average illumination image:

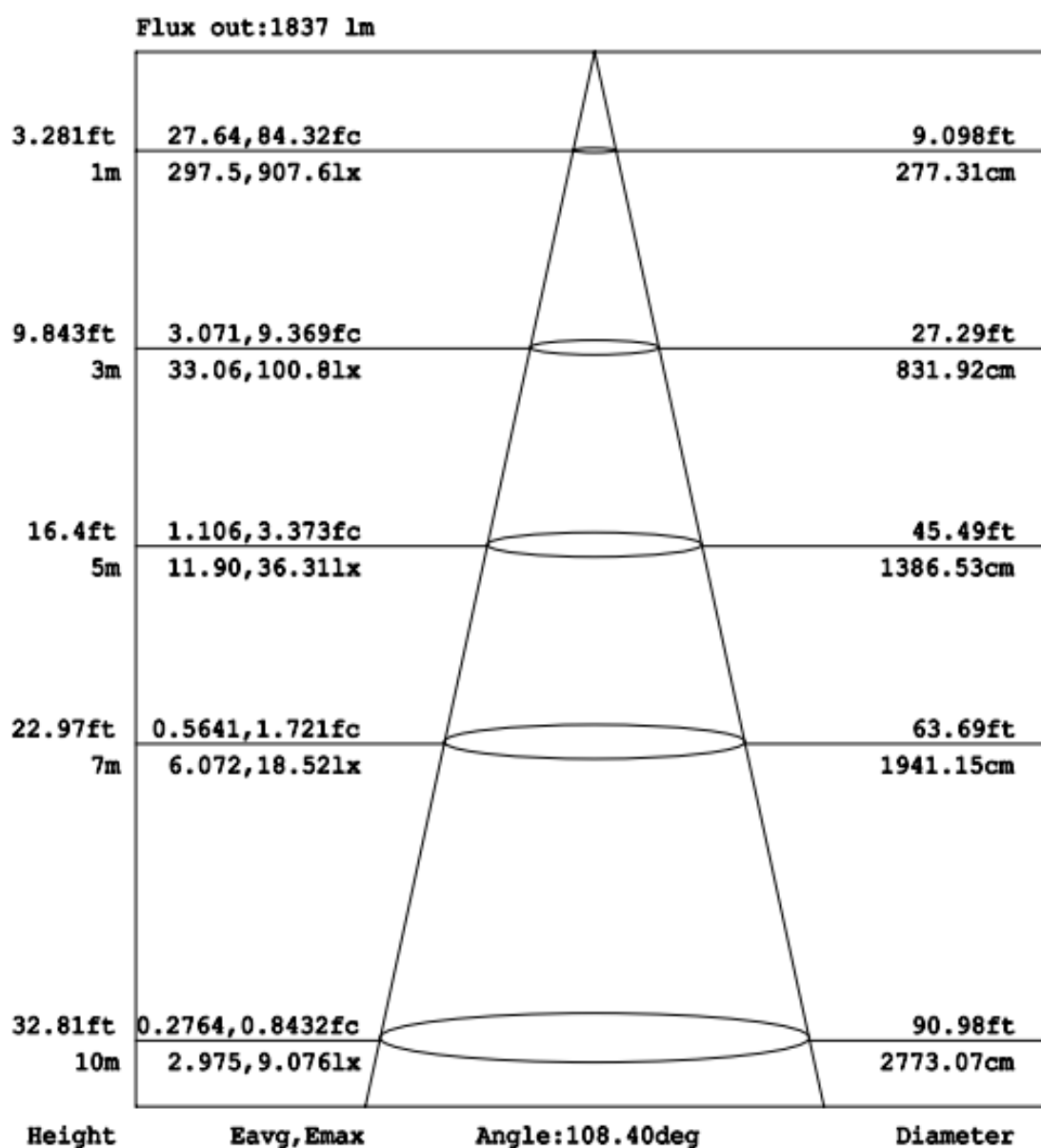

Note: The Curves indicate the illuminated area and the average illumination when the luminaire is at different distance.

## Installation:

### Step 1

Opening package, take out lamp and accessories, check the accessories are complete or not, if the glass is damaged please ask for suppliers to replace immediately.

### Step 2

Lights can install on the ground, wall or brackets according to actual situation such as installation on the brackets with hexagonal head screw fixed. And dig the hole on ground or wall with suitable expansion bolt fixing according to light's bracket if install on the ground or wall. As drawing:

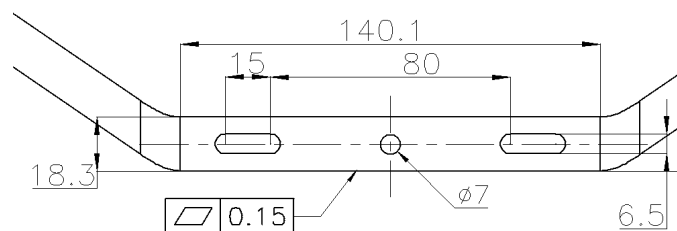

### Step 3

After fixing light body, unscrew from both side, then tighten the screws when turns the light to the correct angle

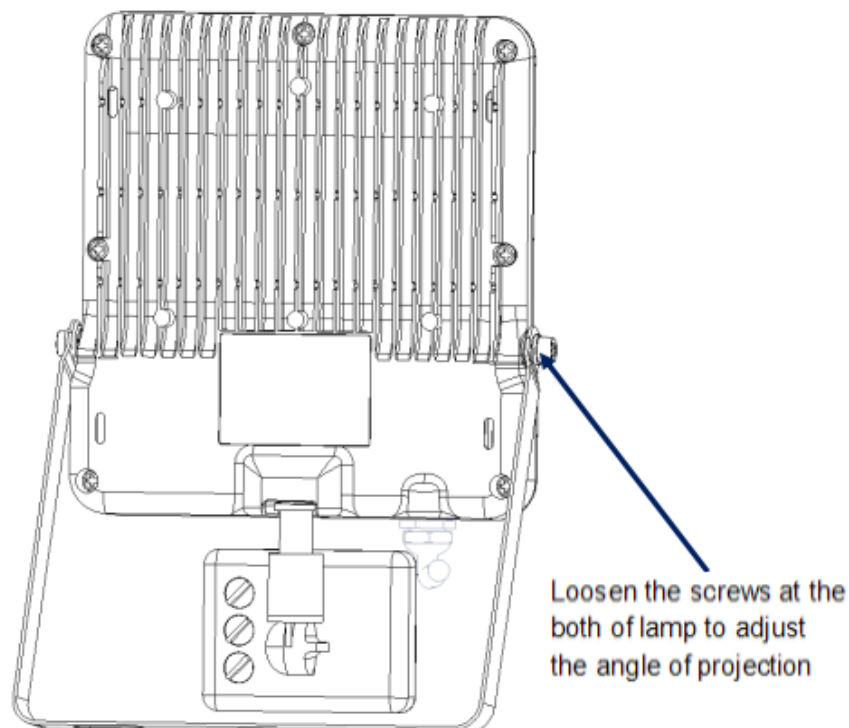

### Step 4

Connection line: brown wire connects the fire wire, blue line connects the null line, and yellow-green line connects ground wire.

## Packing:

Package	Dimension(mm)	Box & CTN	Qty	Net\gross weight (Kg)	
Inner box	172*59*262mm	1PCS/boxes	1PCS	0.56Kg	0.62Kg
Outer Carton	360*315*545mm	2 layer /CTN	20PCS	13.4Kg	

## Attention:

- 1、 Please take care of glass part when moving;
- 2、 Do not disassemble the lights if not professional;
- 3、 The working power is high voltage alternating current which is installed in out of reach by people,the wire core shall not be exposed while connecting,and do ground protection
- 4、 Place for installation must be carrying capacity enough to ensure the safety;
- 5、 Please don't touch the light cup by hand when working , in order not to be scalded.
- 6、 Working ambient temperature should be less than 45℃.Otherwise, It will effect the lifespan of products.Keep it well;
- 7、 Do not work over the range of voltage to ensure the lifespan of barretter;
- 8、 This product has tri-proof.It can work in rain but couldn't soak into the water;
- 9、 Clear the dust in one time to keep the good heat dispersion. Be noted that do not clear the products with corrosive liquid;
- 10、 Ask for professional to installation or maintainece;
- 11、 It is a normal phenomenon that appear mist inside the product surface.
- 12、 Waterproof treatment must do well in Three-core wire exposed, otherwise the water is sucked inside the lamp and cause dead lights phenomenon.

**Attention: Won't notice if any information changed. Any doubts please contact supplier directly!**