



You can hear the difference!

| | | | | | | |
|---------------------------------|-------------------------|----------------------|----------------------------|-------------------------|-------------------------|--------------------------|
| Speaker Systems | Drivers | Kits | Multimedia | Company | Support | Purchase |
|---------------------------------|-------------------------|----------------------|----------------------------|-------------------------|-------------------------|--------------------------|

W6 Bass-Midrange

It applied Germany Super-PPF ultra-strong high damping film membrane and high loss fatigue resistant ultra-thin rubber fold ring has smooth and wide frequency response, full-bodied timbre, and low distortion in intermediate frequency. Non-eddy loss Kapton voice coil frame and heat resistant SV circuit voice coil has high power handling; high performance double magnet entire coupling shield anti-magnet magnetic circuit system long stroke linear displacement design has forceful and abundant bass. Finite element precision computer stimulation design integrated high density aluminum trough avoid parasitical structure resonance and sound contamination. Gaining symmetry actuation power, special Swans symmetry magnetic field (SMD) actuation technology makes voice coil situate in a symmetry magnetic field, which obviously reduced the voice coil inductance and mutual brewage of anti-electromotive force, improved the loudspeaker control ability. It has abundant bass and low distortion.

W5 was optimizing designed for balance frequency response and avoiding produce resonance in high frequency. Avoiding air pressure and inner air resonance, W5 applied inner venting style. Magnet shield structure made W6 widely applied in AV situations.

W5 applied Swans leading field Small/Thiele parameter optimizing design technology facilitate box body design.

It suit for HI-Fi 2-way reflex shelf style speaker system, intermediate & low frequency of 3-way reflex console-module speaker, and ultra-low units of ultra-low frequency.

Products Graph:

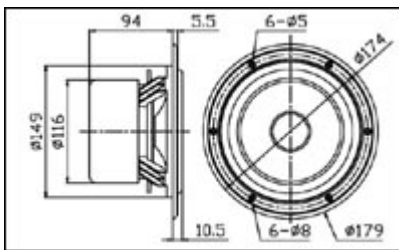

Mechanical Drawing
(Magnify)

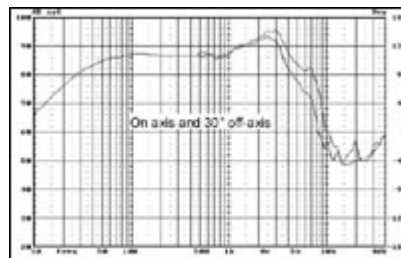

Frequency Response
(Magnify)

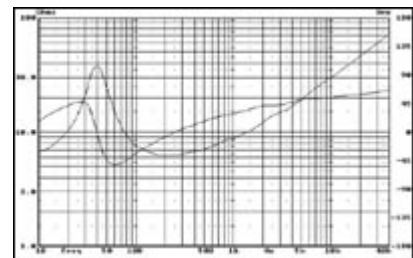

Impedance
(Magnify)

[More picture](#)

Woofer W series:

W6 Bass-Midrange

| | |
|------------------------------------|------|
| Nominal Impedance (Z)(O) : | 8 |
| Resonance Frequency (Fs)(Hz) : | 40 |
| Nominal Power Handling (Pnom)(W) : | 45 |
| Max Power Handling (Pmax)(W) : | 90 |
| Sensitivity (2.83v/1m)(dB) : | 86 |
| Weight (M)(Kg) : | 2.5 |
| VC Diameter (mm) : | 25 |
| DC (Re)(O) : | 6.5 |
| VC Length (H)(mm) : | 14.5 |



| | |
|-------------------------------------|----------|
| VC Former : | SV |
| VC Frame : | Kapton |
| Magnet System : | Shielded |
| Magnet Former : | Ferrite |
| Force Factor (BL)(TM) : | 6.7 |
| Gap Height (He)(mm) : | 6.0 |
| Linear Excursion (Xmax)(mm) : | 4.3 |
| Suspension Compliance (Cms)(uM/N) : | 913 |
| Mechanical Q (Qms) : | 3.04 |
| Electrical Q (Qes) : | 0.64 |
| Total Q (Qts) : | 0.52 |
| Moving Mass (Mms)(g) : | 17.1 |
| Effective Piston Area (Sd)(m2) : | 0.0139 |
| Equivalent Air Volume (Vas)(L) : | 25.1 |
| Cabinet Type : | Vented |
| Recommended Box Volume(Vb)(L) : | 22 |
| Tuning Frequency(Fb)(Hz) : | 42 |
| -3dB Cut-Off Frequency(F3)(Hz) : | 40 |

©2004 Swans Speaker Systems Inc.(USA) All rights reserved.