



You can hear the difference!

Speaker Systems	Drivers	Kits	Multimedia	Company	Support	Purchase
---------------------------------	-------------------------	----------------------	----------------------------	-------------------------	-------------------------	--------------------------

[Home Theater systems](#) [Hi-End Speaker systems](#) [Professional Loudspeakers](#) [CEDIA:Ceilir](#)

K1 Hi-end Tweeter

K1 tweeter is of Swans new first-class ball top high frequency loudspeaker applied Germany natural fibre first-class film membrane; special painted damp greatly improved sound quality of high frequency. It has advantages of smooth frequency response, above 20kHz high frequency, high clarity, well transient response, natural tamber, having heat-resistant aluminum magnesium alloy framework and beautiful appearance.

K1 tweeter has wide frequency response, small unequal level, exquisite and natural tabmer, and well energy feeling of intermediate frequency; it is a fantastic tweeter and widely-applied.

Products Graph:

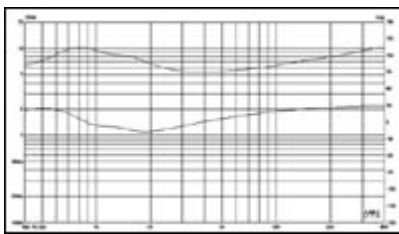

Impedance
(Magnify)

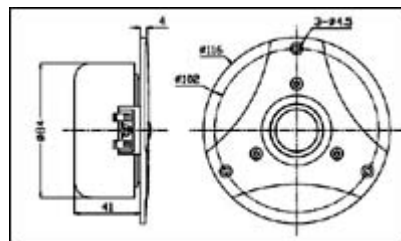

Mechanical Drawing
(Magnify)

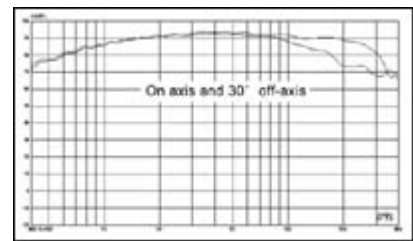

Frequency Response
(Magnify)

[More picture](#)

Tweeter:



K1 Hi-end Tweeter

Nominal Impedance (Z)(O) :	5
Resonance Frequency (Fs)(Hz) :	800
Nominal Power Handling (Pnom)(W) :	15
Sensitivity (2.83v/1m)(dB) :	92
Weight (M)(Kg) :	0.9
VC Diameter (mm) :	25
DC (Re)(O) :	4.6
VC Layers :	2
VC Former :	CCAW
VC Frame :	ALuminum
Magnet System :	Shielded
Magnet Former :	Ferrite
Recommended Crossover Frequency (Hz) :	>2500Hz