

THERMOSTATS **KSD 301**



Fig.1 Photos of the thermostats

- Non-adjustable thermostats with bimetal plate, which belong to the KSD series, designed for power electric circuit opening, when the temperature reaches to an exact value.
- **Function:**
to protect the systems of superheating, to support the temperature in exact range.
- **Application:**
in boilers, water heaters, vacuum cleaners, copiers, electric stoves, ovens, dryers, refrigerators, dish washers, air-conditioners, etc.
- **Electric join-up**
one of the thermostat`s leads connects with the *phase* conductor, the other lead-with the respective terminal for supply of the switch (five-position, etc.). If such switch lacks, the second lead of the thermostat connects with any heater`s lead (the second lead of the heater must connect to the *null (neutral)*).

ATTENTION!

Before to begin to work with electric equipment, you must become sure, that the supply voltage is switched off (by overload release, fuse, circuit breaker, main switch)!

TECHNICAL DATA

Rated voltage and current	16A 125 VAC (Active Load) 10A 250 VAC (Active Load) 16A 250 VAC (Active Load)
Operating temperature	50°C ÷ 175°C
Differential	10°C ÷ 30°C (15°C standard)
Temperature tolerance :	Operating temperature ±3°C ±5°C
Heat durability	220°C max. (PPS)
Contact configuration	SPST-NC
Closed contact's circuit resistance	0.05 Ω max.
Insulation resistance	100 MΩ min. at 500 VDC
Dielectric strength	1 kVAC for one minute. or 1.8 kVAC for one second
Operating Life	100000 cycles (16 A 125 VAC/10 A 250 VAC) 10000 cycles (16A 250 VAC)

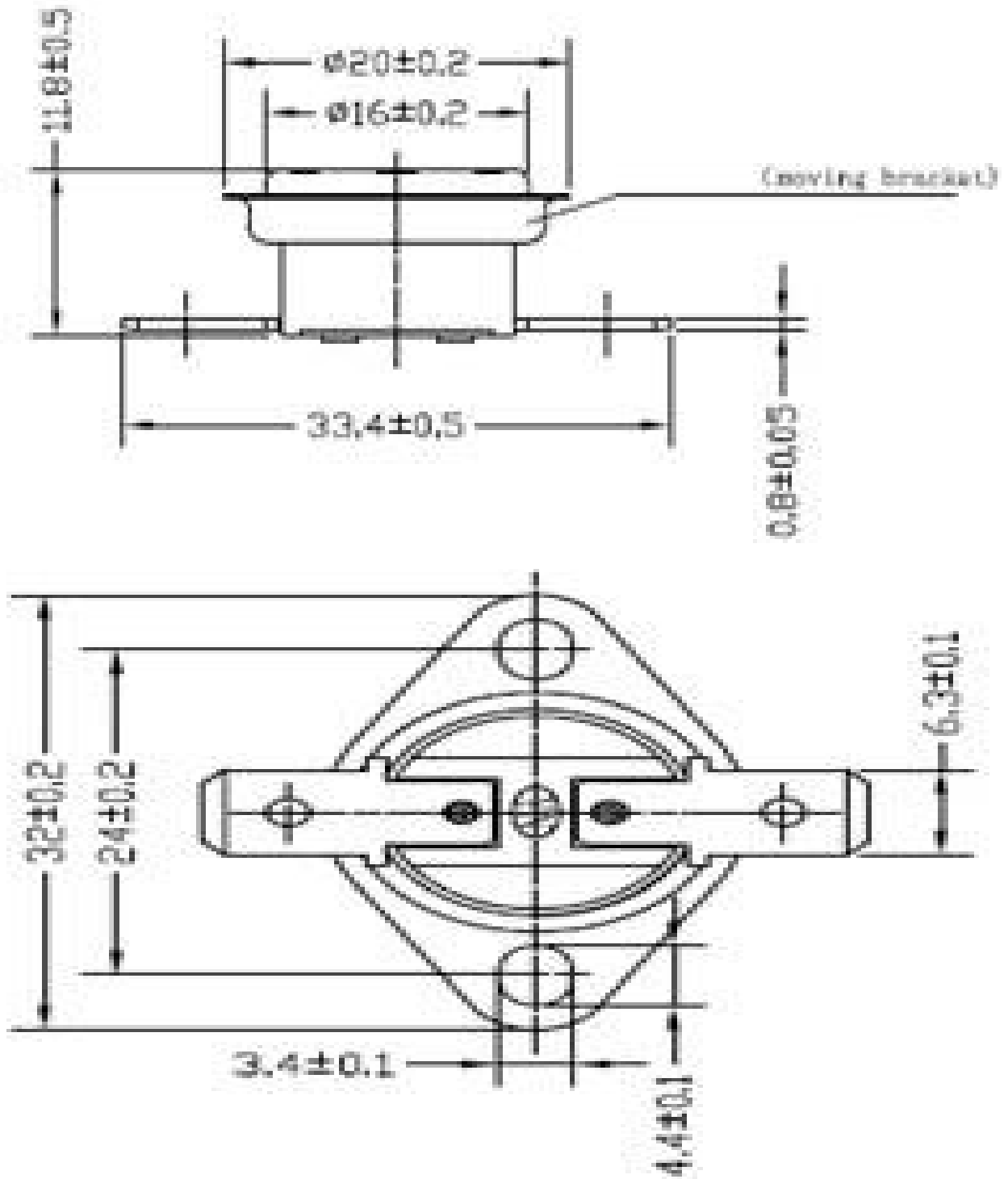

Fig.2 Drawing of KSD 301A